

# Wylfa Newydd Project

## Volume 2: Plans, Sections and Drawings (Part 16/19)

### 2.13 Off-site Power Station Facilities

PINS Reference Number: EN010007

---

Application Reference Number: 2.13

---

June 2018

Revision 1.0

Regulation Number: 5(2)(o)

Planning Act 2008

Infrastructure Planning (Applications: Prescribed Forms and Procedure) Regulations 2009

# Contents

WN0902-HZDCO-ADV-DRG-00001	OFF-SITE POWER STATION FACILITIES, LLANFAETHLU, PARAMETER PLAN
WN0902-HZDCO-ADV-DRG-00002	OFF-SITE POWER STATION FACILITIES, LLANFAETHLU, SITE LAYOUT PLAN
WN0902-HZDCO-ADV-DRG-00003	OFF-SITE POWER STATION FACILITIES, LLANFAETHLU, PROPOSED CLEARANCE, AND DEMOLITION PLAN
WN0902-HZDCO-ADV-DRG-00004	OFF-SITE POWER STATION FACILITIES, LLANFAETHLU, PROPOSED LANDSCAPE, MASTERPLAN AND FINISHED LEVELS
WN0902-HZDCO-ADV-DRG-00005	OFF-SITE POWER STATION FACILITIES, LLANFAETHLU, PROPOSED HIGHWAYS, GENERAL ARRANGEMENT PLAN
WN0902-HZDCO-ADV-DRG-00006	OFF-SITE POWER STATION FACILITIES, LLANFAETHLU, PROPOSED EXTERNAL, LIGHTING PLAN
WN0902-HZDCO-ADV-DRG-00007	OFF-SITE POWER STATION FACILITIES, LLANFAETHLU, PROPOSED SURFACE WATER AND FOUL WATER, DRAINAGE PLAN
WN0902-HZDCO-ADV-DRG-00008	OFF-SITE POWER STATION FACILITIES, LLANFAETHLU - SITE UTILITIES AND, PROPOSED CONNECTIONS TO, EXISTING STATUTORY UNDERTAKERS
WN0902-HZDCO-ADV-DRG-00009	OFF-SITE POWER STATION FACILITIES, LLANFAETHLU, EXISTING AND PROPOSED SITE, CROSS SECTIONS
WN0902-HZDCO-ADV-DRG-00010	OFF-SITE POWER STATION FACILITIES, LLANFAETHLU - MOBILE EMERGENCY, EQUIPMENT GARAGE AND ALTERNATIVE, EMERGENCY CONTROL CENTRE ROOF PLAN
WN0902-HZDCO-ADV-DRG-00011	OFF-SITE POWER STATION FACILITIES, LLANFAETHLU - MOBILE EMERGENCY, EQUIPMENT GARAGE AND ALTERNATIVE, EMERGENCY CONTROL CENTRE ELEVATIONS
WN0902-HZDCO-ADV-DRG-00012	OFF-SITE POWER STATION FACILITIES, LLANFAETHLU, ENVIRONMENTAL SURVEY LABORATORY, ROOF PLAN
WN0902-HZDCO-ADV-DRG-00013	OFF-SITE POWER STATION FACILITIES, LLANFAETHLU, ENVIRONMENTAL SURVEY LABORATORY, ELEVATIONS
WN0902-HZDCO-ADV-DRG-00015	OFF-SITE POWER STATION FACILITIES, LLANFAETHLU, MISCELLANEOUS BUILDINGS AND, STRUCTURES - PLANS AND ELEVATIONS

NOT PROTECTIVELY MARKED

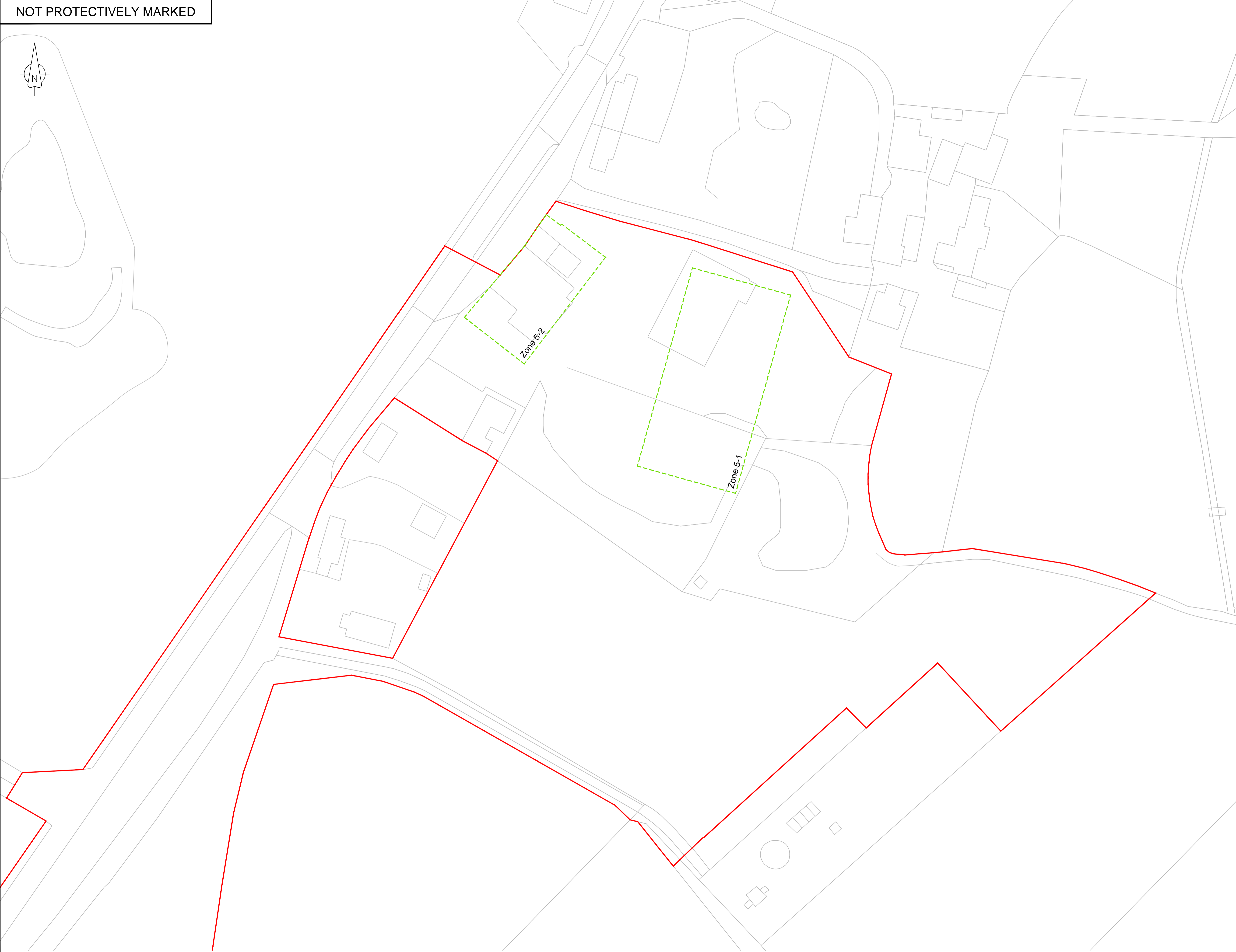

Atgynhychwyd o fapiau'r Arolwg Ordans gyda chaniatâd Rheolwr Llyfrfa Ei Mawrhydi © Hawlfraint y Goron. Mae atgynhychu heb ganiatâd yn torri hawlfraint y Goron a gallech gael eich erlyn neu gallai achos sifil gael ei ddwyn yn eich erbyn. Rhif Trwydded yr Arolwg Ordans 100051118.

Reproduced from Ordnance Survey mapping with the permission of the Controller of Her Majesty's Stationery Office  
© Crown copyright. Unauthorised reproduction infringes Crown copyright and may lead to prosecution or civil proceedings. Ordnance Survey Licence number 100051118.

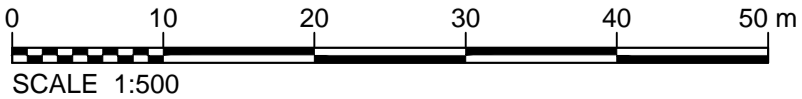

NOTES

1. The order limits shown on this plan include some land which will be used for the purposes of the Off-line Highways Section 5.

LEGEND

Order Limits

Maximum Extent of Parameter Zone

1.0	MARCH 2018	FOR DCO SUBMISSION				HNPWL	HNPWL	HNPWL
Rev	Rev. Date	Purpose of revision				Drawn	Checked	Apprv'd

FOR APPROVAL

HORIZON

NUCLEAR POWER

Sunrise House, 1420 Charlton Court, Gloucester Business Park, Gloucester, GL3 4AE, UK  
Freephone: 0845 300 6816 Email: [info@horizonnuclearpower.com](mailto:info@horizonnuclearpower.com)

Project

WYLFA NEWYDD  
DCO PROJECT

Drawing Title

OFF-SITE POWER STATION FACILITIES  
- LLANFAETHLU  
PARAMETER PLAN

Regulation 5 (2) (o)

Security Status

NOT PROTECTIVELY MARKED

Scale	1:500	Sheet Size	A1	Sheet(s)	1 of 1	Rev		
Drawing Number	WN0902-HZDCO-ADV-DRG-00001						Rev	1.0

© Copyright Horizon Nuclear Power Wylfa Limited. Not to be reproduced (in full or part) without prior permission of Horizon Nuclear Power Wylfa Limited.

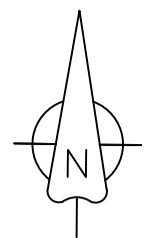

Pedestrian access and gate

Entrance sign 2m L x 0.1m W x 1m H 1m  
above ground

Below ground proposed foul  
water package pumping  
station with alarm

☐ Parking

45025

Grass 0

Grass S.

Oversp  
Car  
Parking

Gated entry to allow maintenance / access to new gravity sewer

Atgynhyrchwyd o fapiau'r Arolwg Ordnans gyda chaniatâd Rheolwr Llyfrfa Ei Mawrhydi © Hawlfraint y Goron. Mae atgynhyrchu heb ganiatâd yn torri hawlfraint y Goron a gallech gael eich erlyn neu gallai achos sifil gael ei ddwyn yn eich erbyn. Rhif Trwydded yr Arolwg Ordnans 100051118.

Reproduced from Ordnance Survey mapping with the permission of the Controller of Her Majesty's Stationery Office © Crown copyright. Unauthorised reproduction infringes Crown copyright and may lead to prosecution or civil proceedings. Ordnance Survey Licence number 100051118.

### LEGEND

- |  |   |
|--|---|
|     | Order Limits                                      |
|   | Road surface                                      |
|   | Footway / pedestrian route surface                |
|   | Permeable road surfacing / permeable road surface |
|   | Existing lay-by to be resurfaced                  |
|   | Soft landscaping                                  |
|   | Native tree and shrub planting                    |
|   | Retained hedgerow                                 |
|   | Hedgerow planting                                 |
|   | Existing watercourse                              |
|   | Discharge location                                |
|   | Close boarded domestic fencing                    |
|   | Security fence (2400mm paladin type)              |
|   | Proposed stone wall                               |
|   | Retained stone wall                               |
|   | Pedestrian crossing                               |
|   | Gate and barrier access / secure gate             |
|   | Disabled parking                                  |
|   | Road barrier                                      |
|   | Embankment/cutting locations                      |
|   | Under ground fuel tank                            |
|   | Portacabins and containers                        |
|   | Enclosures  |
|  | Below ground package pumping station with alarm   |

### Buildings - Proposed

- |   |  |
|---|--|
| A | Proposed MEEG (Mobile Emergency Equipment Garage) / AECC (Alternative Emergency Control Centre) building |
| B | Proposed ESL (Environmental Survey Laboratory) building  |
| C | Substation (with anti climb measures)  |
| D | Sprinkler Pumphouse  |
| E | Generator  |
| F | External plant area  |
| G | Refuse (with anti climb measures)  |
| H | Fuel pump  |

1.0	MARCH 2018	FOR DCO SUBMISSION	HNPWL	HNPWL	HNPWL
Rev	Rev. Date	Purpose of revision	Drawn	Checked	Appr'd

ILLUSTRATIVE



Sunrise House, 1420 Charlton Court, Gloucester Business Park, Gloucester, GL3 4AE, UK  
Freephone: 0845 300 6816 Email: [info@horizonnuclearpower.com](mailto:info@horizonnuclearpower.com)

Project	WYLFA NEWYDD DCO PROJECT
---------	-----------------------------

Drawing Title

OFF-SITE POWER STATION FACILITIES  
LLANFAETHLU  
SITE LAYOUT PLAN

Regulation 5 (2) (o)

Security Status NOT PROTECTIVELY MARKED

Scale	1:500	Sheet Size	A1	Sheet(s)	1 of 1
Drawing Number WN0902-HZDCO-ADV-DRG-00002					Rev 1.0

© Copyright Horizon Nuclear Power Wylfa Limited. Not to be reproduced (in full or part) without prior permission of Horizon Nuclear Power Wylfa Limited.



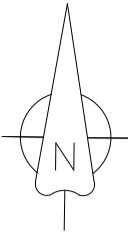

NOTES

1. All levels are in metres above ordnance datum unless noted otherwise.

LEGEND

- Order Limits
- Extent of existing buildings to be demolished
- Existing walls to be demolished
- Extent of site clearance area of existing hardstanding and vegetation
- Extent of site clearance for construction works within the site boundary
- Extent of site clearance for overspill parking zone within the site boundary
- Existing site bund to be removed
- Retained hedgerow
- Retained stone wall

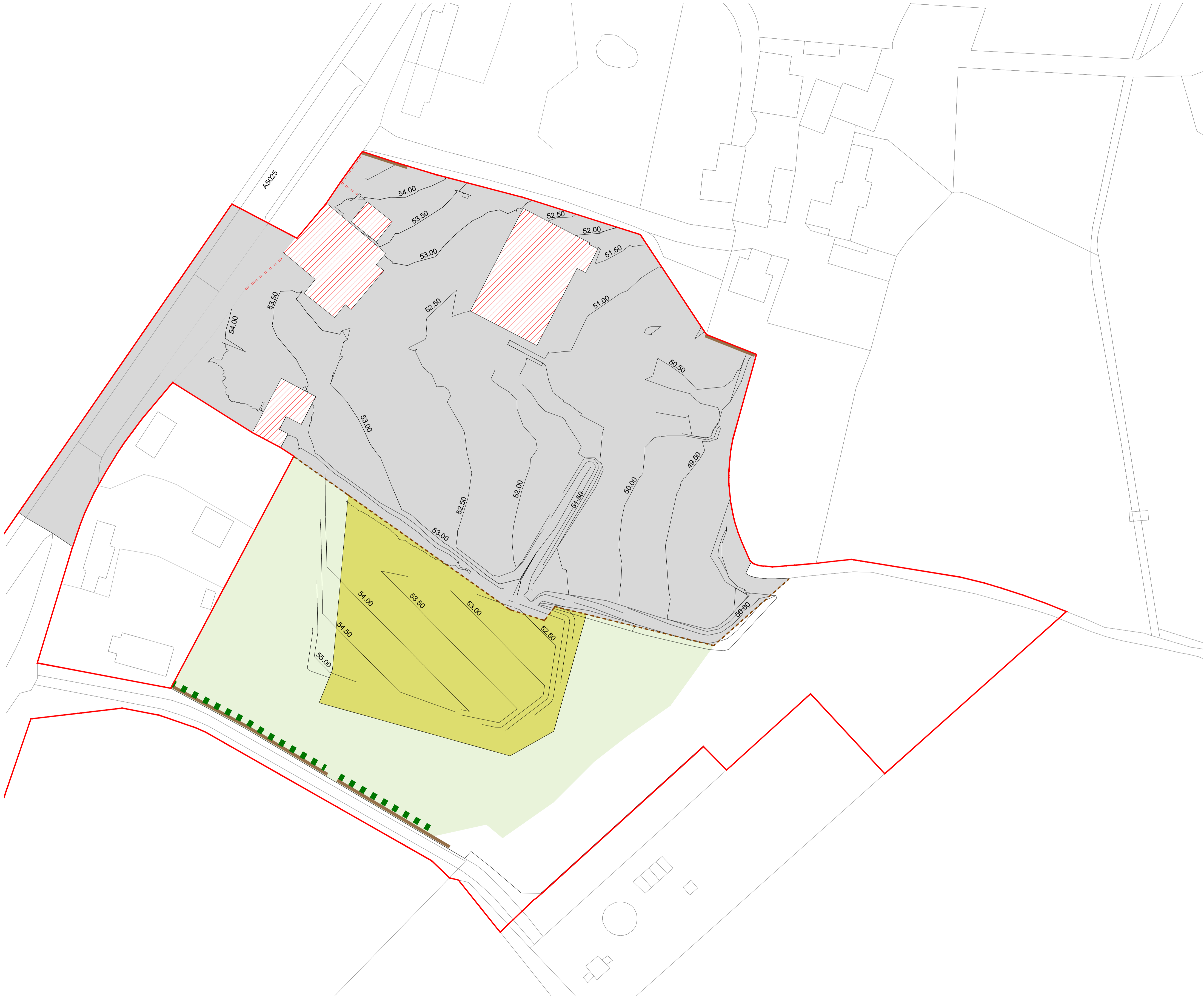

1.0	MARCH 2018	FOR DCO SUBMISSION	HNPWL	HNPWL	HNPWL
Rev	Rev. Date	Purpose of revision	Drawn	Checked	Approved

ILLUSTRATIVE

**HORIZON**  
NUCLEAR POWER

Sunrise House, 1420 Charlton Court, Gloucester Business Park, Gloucester, GL3 4AE, UK  
Freephone: 0845 300 6816 Email: info@horizonnuclearpower.com

Project  
**WYLFA NEWYDD  
DCO PROJECT**

Drawing Title  
**OFF-SITE POWER STATION FACILITIES  
LLANFAETHLU  
PROPOSED CLEARANCE  
AND DEMOLITION PLAN**

Regulation 5 (2) (o)

Security Status  
**NOT PROTECTIVELY MARKED**

Scale	1:500	Sheet Size	A1	Sheet(s)	1 of 1
Drawing Number	WN0902-HZDCO-ADV-DRG-00003				Rev 1.0

Atgynhychwyd o fapiau'r Arolwg Ordnans gyda chaniatâd Rheolwr Llyfrfa Ei Mawrhydi © Hawlfraint y Goron.  
Mae atgynhychu heb ganiatâd yn torri hawlfraint y Goron a gallech gael eich erlyn neu gallai achos sifil gael ei  
ddwyn yn eich erbyn. Rhif Trwydded yr Arolwg Ordnans 100051118.

Reproduced from Ordnance Survey mapping with the permission of the Controller of Her Majesty's Stationery  
Office © Crown copyright. Unauthorised reproduction infringes Crown copyright and may lead to prosecution  
or civil proceedings. Ordnance Survey Licence number 100051118.

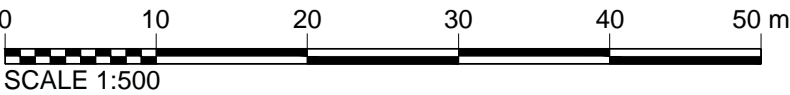

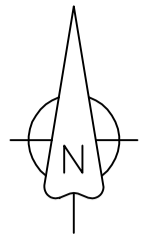

NOTES

1. All levels are in metres above ordnance datum unless noted otherwise.

LEGEND

- Order Limits**
- Softworks - existing**
- Retained hedgerow
- Softworks - proposals**
- Hedgerow planting
  - Native tree and shrub planting
  - Native shrub planting
  - Grassland - species rich
- Hardworks - Existing**
- Retained stone wall
  - Existing lay-by to be resurfaced
- Hardworks - Proposals**
- Proposed stone wall
  - Security fence (2400mm paladin type)
  - Gate and barrier access / secure gate
  - Disabled parking
  - Pedestrian crossing
  - Close boarded domestic fence
  - Underground fuel tank
  - Vehicle surfacing
  - Proposed permeable surfacing / Permeable road surface
  - Pedestrian surfacing
  - Below ground package pumping station with alarm
- Water - Existing**
- Water course retained
- Water - Proposed**
- Discharge location
- Buildings - Proposed**
- Proposed MEEG (Mobile Emergency Equipment Garage) / AECC (Alternative Emergency Control Centre) building
  - Proposed ESL (Environmental Survey Laboratory) building
  - Enclosures
  - Portacabins and containers

1.0	MARCH 2018	FOR DCO SUBMISSION	HNPWL	HNPWL	HNPWL
Rev	Rev. Date	Purpose of revision	Drawn	Checked	Apprv'd

ILLUSTRATIVE

**HORIZON**  
NUCLEAR POWER

Sunrise House, 1420 Charlton Court, Gloucester Business Park, Gloucester, GL3 4AE, UK  
Freephone: 0845 300 6816 Email: info@horizonnuclearpower.com

Project  
**WYLFA NEWYDD  
DCO PROJECT**

Drawing Title  
**OFF-SITE POWER STATION FACILITIES  
LLANFAETHLU  
PROPOSED LANDSCAPE  
MASTERPLAN AND FINISHED LEVELS  
Regulation 5 (2) (o)**

Security Status  
**NOT PROTECTIVELY MARKED**

Scale	1:500	Sheet Size	A1	Sheet(s)	1 of 1
-------	-------	------------	----	----------	--------

Drawing Number  
**WN0902-HZDCO-ADV-DRG-00004**

Rev  
**1.0**

Atgynhychwyd o fapiau'r Arolwg Ordnans gyda chaniatâd Rheolwr Llyfrfa Ei Mawrhydi © Hawlfraint y Goron. Mae atgynhyrchu heb ganiatâd yn torri hawlfraint y Goron a gallech gael eich erlyn neu gallai achos sifil gael ei ddwyn yn eich erbyn. Rhif Trwydded yr Arolwg Ordnans 100051118.

Reproduced from Ordnance Survey mapping with the permission of the Controller of Her Majesty's Stationery Office © Crown copyright. Unauthorised reproduction infringes Crown copyright and may lead to prosecution or civil proceedings. Ordnance Survey Licence number 100051118.



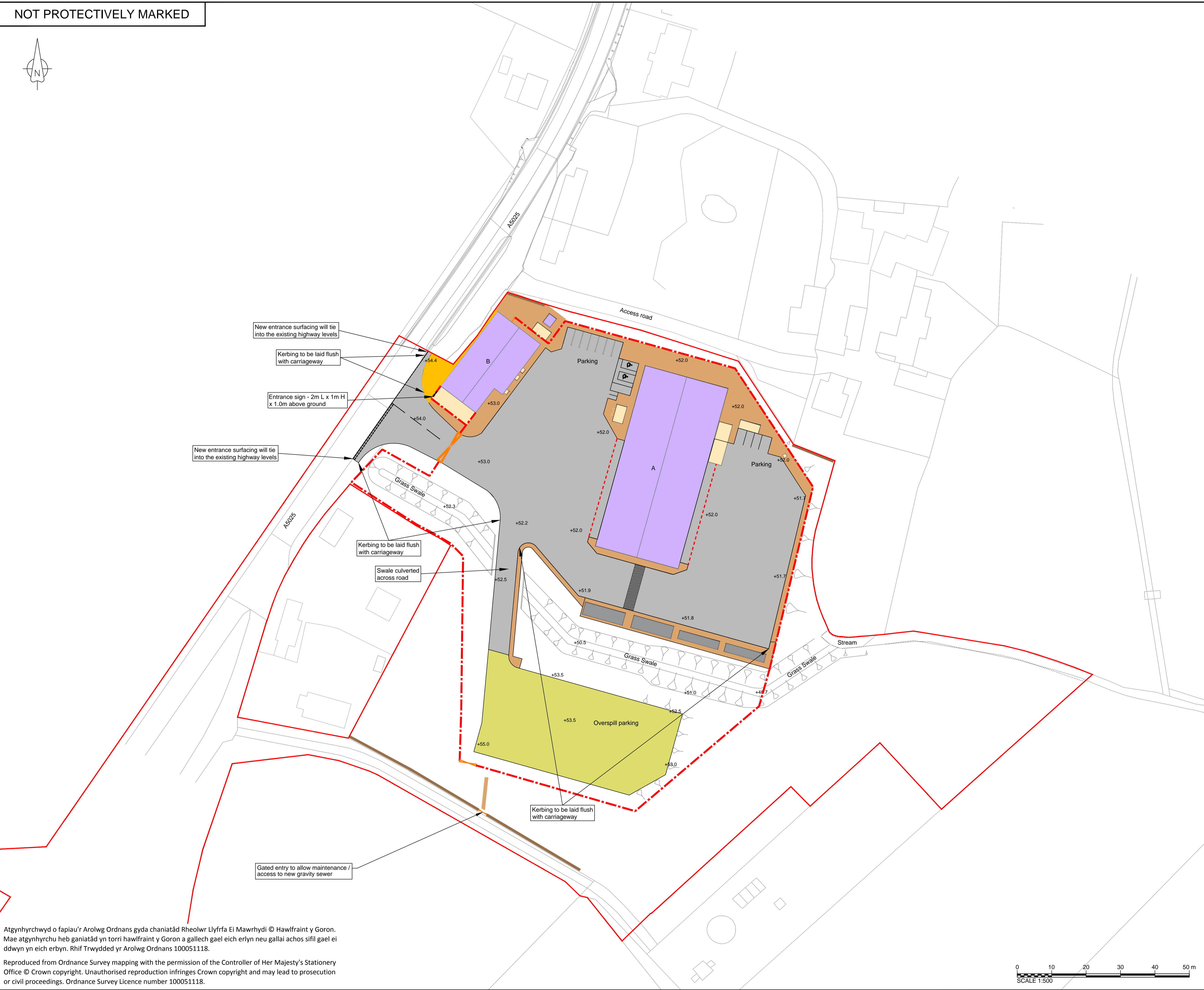
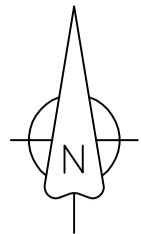

NOTES

1. All levels are in metres above ordnance datum unless noted otherwise.

LEGEND

- Order Limits
- Hardworks - Proposals**
- Proposed asphalt pavement construction
  - Proposed concrete pavement construction
  - Proposed permeable surfacing / permeable road surface
  - Proposed footway
  - Existing lay-by to be resurfaced
  - Security fence (2400mm paladin type)
  - Pedestrian crossing
  - Gate and barrier access / secure gate
  - Disabled parking
  - Slot drain at base of slope from building
- Buildings - Proposed**
- Proposed MEEG (Mobile Emergency Equipment Garage) / AECC (Alternative Emergency Control Centre) building
  - Proposed ESL (Environmental Survey Laboratory) building
- Enclosures
- Hardworks - Existing**
- Retained stone wall

1.0	MARCH 2018	FOR DCO SUBMISSION	HNPWL	HNPWL	HNPWL
Rev	Rev. Date	Purpose of revision	Drawn	Checked	Apprv'd

ILLUSTRATIVE

**HORIZON**  
NUCLEAR POWER

Sunrise House, 1420 Charlton Court, Gloucester Business Park, Gloucester, GL3 4AE, UK  
Freephone: 0845 300 6816 Email: info@horizonnuclearpower.com

Project  
**WYLFA NEWYDD  
DCO PROJECT**

Drawing Title  
**OFF-SITE POWER STATION FACILITIES  
LLANFAETHLU  
PROPOSED HIGHWAYS  
GENERAL ARRANGEMENT PLAN**

Regulation 5 (2) (o)

Security Status  
**NOT PROTECTIVELY MARKED**

Scale 1:500 Sheet Size A1 Sheet(s) 1 of 1

Drawing Number  
**WN0902-HZDCO-ADV-DRG-00005** Rev  
**1.0**

Atgynhychwyd o fapiau'r Arolwg Ordnans gyda chaniatâd Rheolwr Llyfrfa Ei Mawrhydi © Hawlfraint y Goron. Mae atgynhyrchu heb ganiatâd yn torri hawlfraint y Goron a gallech gael eich erlyn neu gallai achos sifil gael ei ddwyn yn eich erbyn. Rhif Trwydded yr Arolwg Ordnans 100051118.

Reproduced from Ordnance Survey mapping with the permission of the Controller of Her Majesty's Stationery Office © Crown copyright. Unauthorised reproduction infringes Crown copyright and may lead to prosecution or civil proceedings. Ordnance Survey Licence number 100051118.



NOT PROTECTIVELY MARKED

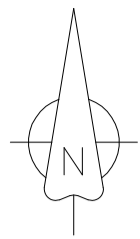

0 1 5 10 m  
SCALE 1:100

COLUMN DETAILS  
SCALE 1:100

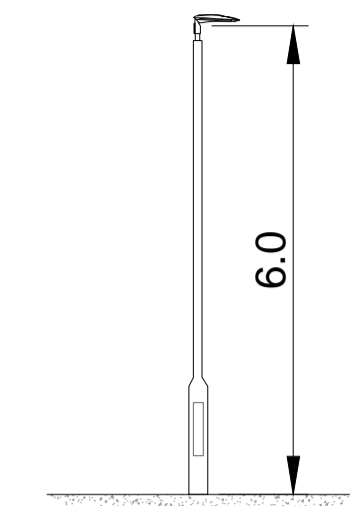

Type A- 6m Column

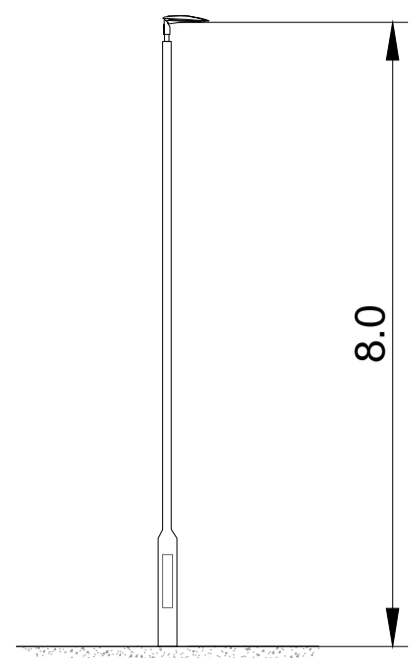

Type B- 8m Column

A09, A10 are for access  
and emergency only

Atgynhychwyd o fapiau'r Arolwg Ordnnans gyda chaniatâd Rheolwr Llyfrfa Ei Mawrhydi © Hawlfraint y Goron.  
Mae atgynhychru heb ganiatâd yn torri hawlfraint y Goron a gallech gael eich erlyn neu gallai achos sifil gael ei  
ddwyn yn eich erbyn. Rhif Trwydded yr Arolwg Ordnnans 100051118.

Reproduced from Ordnance Survey mapping with the permission of the Controller of Her Majesty's Stationery  
Office © Crown copyright. Unauthorised reproduction infringes Crown copyright and may lead to prosecution  
or civil proceedings. Ordnance Survey Licence number 100051118.

0 10 20 30 40 50 m  
SCALE 1:500

Notes

1. All dimensions are in metres unless noted otherwise.

Legend

Statistics

Description	Symbol	Avg Lux	Min Lux	Min/Avg
ESL Building		11.57 lux	4.65 lux	0.40
Car Park		8.74 lux	4.68 lux	0.53
MEEG Building		20.01 lux	7.93 lux	0.40
Footpath		14.07 lux	5.60 lux	0.40

Luminaires

Symbol	Label	QTY	Description	Lamp	No. of Lamps
	A	10	Post top mounted at 6m height	LED C.5000LM-4000K	1
	B	5	Post top mounted at 8m height	LED C.8000LM-4000K	1
	C	10	Wall mounted at 7 m height with a 0.5m bracket	LED C.8000LM-4000K	1

- Order Limits
- Security fence (2400mm paladin type)
- Disabled parking

Buildings - Proposed

- A Proposed MEEG (Mobile Emergency Equipment Garage) / AECC (Alternative Emergency Control Centre) building
- B Proposed ESL (Environmental Survey Laboratory) building

1.0	MARCH 2018	FOR DCO SUBMISSION		HNPWL	HNPWL	HNPWL
Rev	Rev. Date	Purpose of revision		Drawn	Checked	Apprv'd

ILLUSTRATIVE

**HORIZON**  
NUCLEAR POWER

Sunrise House, 1420 Charlton Court, Gloucester Business Park, Gloucester, GL3 4AE, UK  
Freephone: 0845 300 6816 Email: info@horizonnuclearpower.com

Project  
**WYLFA NEWYDD  
DCO PROJECT**

Drawing Title  
**OFF-SITE POWER STATION FACILITIES  
LLANFAETHLU  
PROPOSED EXTERNAL  
LIGHTING PLAN**

Regulation 5 (2) (o)

Security Status					
NOT PROTECTIVELY MARKED					
Scale	As Shown	Sheet Size	A1	Sheet(s)	1 of 1
Drawing Number					Rev
WN0902-HZDCO-ADV-DRG-00006					1.0

© Copyright Horizon Nuclear Power Wylfa Limited. Not to be reproduced  
(in full or part) without prior permission of Horizon Nuclear Power Wylfa Limited.



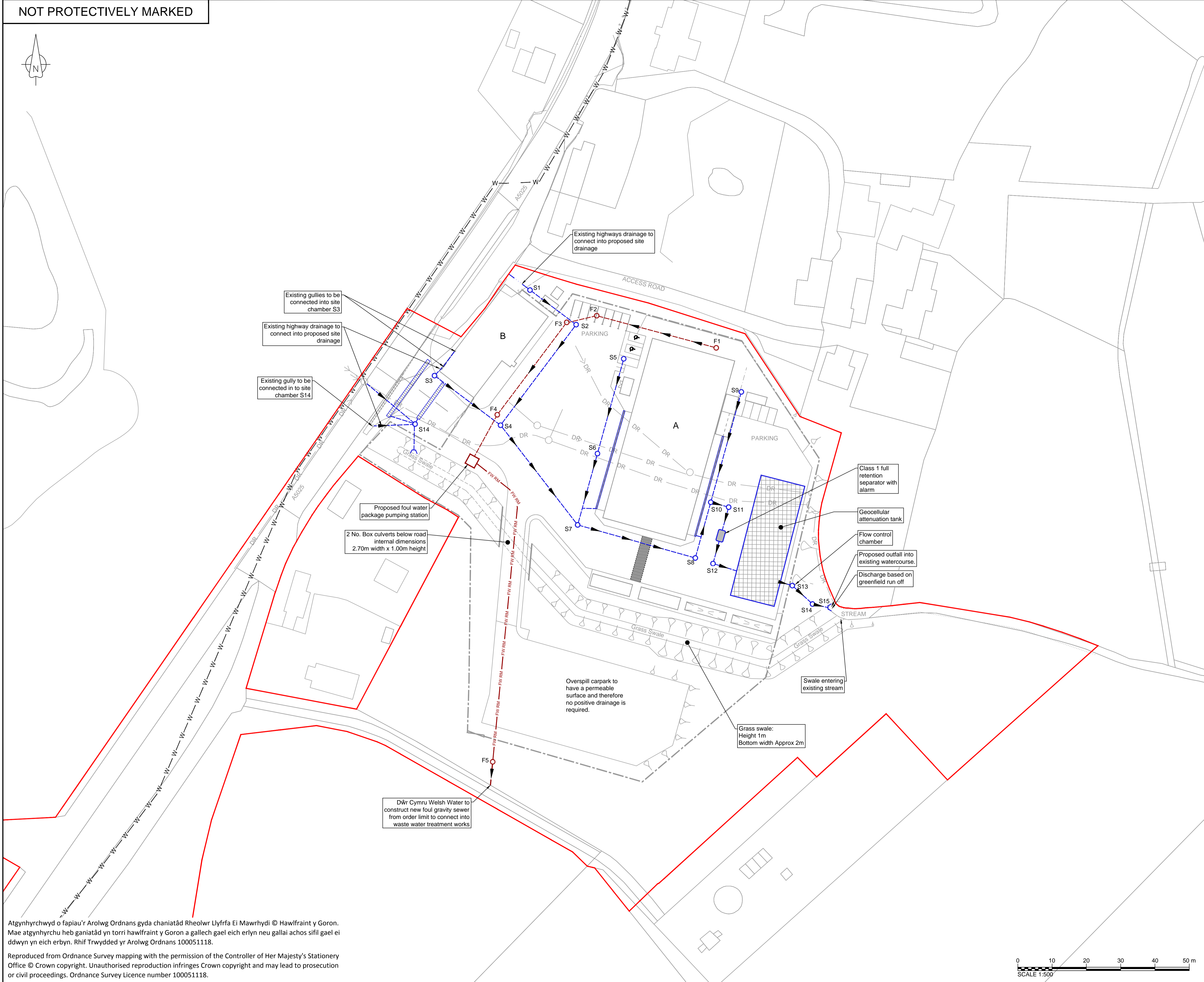
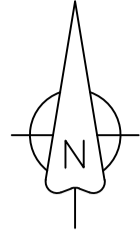













NOT PROTECTIVELY MARKED



NOTES

1. Existing surface water drain to be diverted into swale.
2. Existing highway surface water drainage will be located and removed/abandoned. All drainage associated with the surrounding properties will be retained/diverted as appropriate.
3. The surface water drainage network is proposed with the following requirements:
  - Pipes are designed for flow from a 1 in 5 year storm event plus 20% climate change with no surcharging above soffit
  - No flooding from manholes or above ground (allowing for a 300 mm freeboard below ground level) for a flow from a 1 in 30 year storm plus 20% climate change
  - No significant ponding caused from flow from a 1 in 100 year storm event plus 20% climate change.
6. The drainage system is proposed so that the peak discharge runoff rates for a 1 in 100 year storm event is constrained to greenfield runoff rates for the same event
7. Surface water storage requirements will be provided using geocellular storage systems.
8. Linear/gully receptor drains omitted for clarity. Connections to be minimum of 150mm diameter.

## LEGEND

- |   |   |
|---|---|
|  | Order Limits  |
|  | Security fence (2400mm paladin type)                    |
|  | Proposed surface water sewer                            |
|  | Proposed surface water catchpit                         |
|  | Proposed foul water sewer                               |
|  | Proposed foul water manhole                             |
|  | Proposed foul water rising main                         |
|  | Below ground package pumping station with alarm         |
|  | Pedestrian crossing                                     |
|  | Proposed geocellular storage tank                       |
|  | Proposed full retention separator                       |
|  | Proposed headwall outfall                               |
|  | Existing potable water main                             |
|  | Existing surface water sewer to be diverted and removed |
|  | Proposed surface channel drain                          |
|  | Proposed surface slot drain                             |
|  | Disabled parking  |

### Buildings - Proposed

- |   |  |
|---|--|
| A | Proposed MEEG (Mobile Emergency Equipment Garage) / AECC (Alternative Emergency Control Centre) building |
| B | Proposed ESL (Environmental Survey Laboratory) building  |

1.0	MARCH 2018	FOR DCO SUBMISSION	HNPWL	HNPWL	HNPWL
Rev	Rev. Date	Purpose of revision	Drawn	Checked	Apprv'd

ILLUSTRATIVE



**HORIZON**  
NUCLEAR POWER

Sunrise House, 1420 Charlton Court, Gloucester Business Park, Gloucester, GL3 4AE, UK  
Freephone: 0845 300 6816 Email: [info@horizonnuclearpower.com](mailto:info@horizonnuclearpower.com)

Project	WYLFA NEWYDD DCO PROJECT
---------	-----------------------------

Drawing Title

OFF-SITE POWER STATION FACILITIES  
LLANFAETHLU  
PROPOSED SURFACE AND FOUL WATER  
DRAINAGE PLAN

Regulation 5 (2) (o)

Security Status	NOT PROTECTIVELY MARKED
-----------------	-------------------------

Scale	1:500	Sheet Size	A1	Sheet(s)	1 of 1
Drawing Number					Rev

WN0902-HZDCO-ADV-DRG-00007	1.0
----------------------------	-----

© Copyright Horizon Nuclear Power Wylfa Limited. Not to be reproduced (in full or part) without prior permission of Horizon Nuclear Power Wylfa Limited.

NOT PROTECTIVELY MARKED

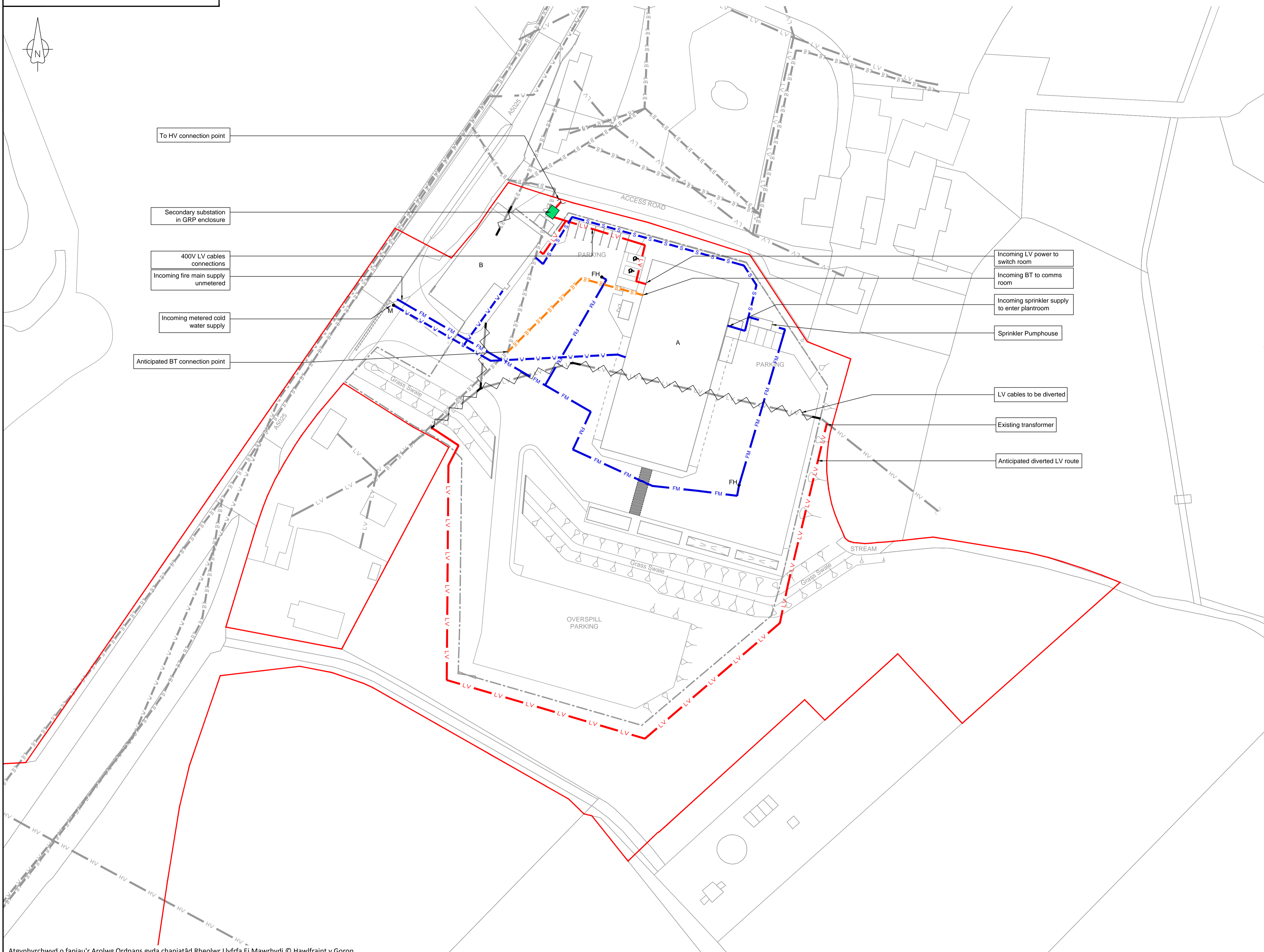
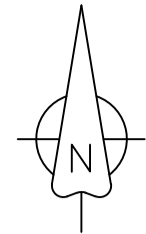

Atgynhychwyd o fapiau'r Arolwg Ordnans gyda chaniatâd Rheolwr Llyfrfa Ei Mawrhydi © Hawlfraint y Goron.  
Mae atgynhychu heb ganiatâd yn torri hawlfraint y Goron a gallech gael eich erlyn neu gallai achos sifil gael ei  
ddwyn yn eich erbyn. Rhif Trwydded yr Arolwg Ordnans 100051118.

Reproduced from Ordnance Survey mapping with the permission of the Controller of Her Majesty's Stationery  
Office © Crown copyright. Unauthorised reproduction infringes Crown copyright and may lead to prosecution  
or civil proceedings. Ordnance Survey Licence number 100051118.

NOTES

1. Locations of services shown are approximate and based on plan information from service providers and others.

LEGEND

- Order Limits**
- Security fence (2400mm paladin type)
- Disabled parking
- Existing services**
- BT - telecoms
- Electrical LV
- Electrical HV
- Water supply
- Proposed services**
- BT - telecoms
- Electrical LV
- Electrical HV
- Water supply
- Fire main supply
- Sprinkler main
- Cables to be diverted or removed
- Secondary substation
- Fire hydrant below ground
- Water meter below ground
- Low voltage
- High voltage
- Volts
- Glass-reinforced plastic
- British Telecom
- Buildings - Proposed**
- Proposed MEEG (Mobile Emergency Equipment Garage) / AECC (Alternative Emergency Control Centre) building
- Proposed ESL (Environmental Survey Laboratory) building

1.0	MARCH 2018	FOR DCO SUBMISSION	HNPWL	HNPWL	HNPWL
Rev	Rev. Date	Purpose of revision	Drawn	Checked	Appr'd

ILLUSTRATIVE

**HORIZON**  
NUCLEAR POWER

Sunrise House, 1420 Charlton Court, Gloucester Business Park, Gloucester, GL3 4AE, UK  
Freephone: 0845 300 6816 Email: info@horizonnuclearpower.com

**WYLFA NEWYDD**  
**DCO PROJECT**

Drawing Title

**OFF-SITE POWER STATION FACILITIES**  
**LLANFAETHLU - SITE UTILITIES AND**  
**PROPOSED CONNECTIONS TO**  
**EXISTING STATUTORY UNDERTAKERS**  
**Regulation 5 (2) (o)**

Security Status						
NOT PROTECTIVELY MARKED						
Scale	1:500	Sheet Size	A1	Sheet(s)	1 of 1	
Drawing Number					Rev	
WN0902-HZDCO-ADV-DRG-00008					1.0	

© Copyright Horizon Nuclear Power Wylfa Limited. Not to be reproduced  
(in full or part) without prior permission of Horizon Nuclear Power Wylfa Limited.

NOT PROTECTIVELY MARKED

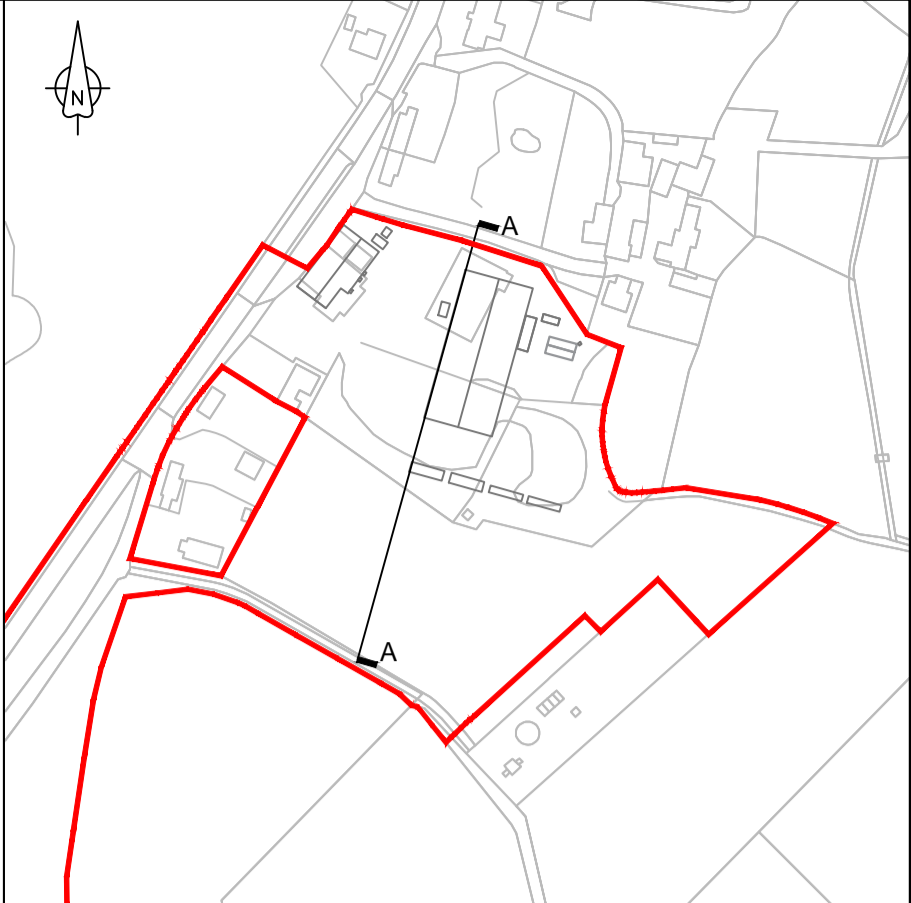

SITE SECTION LOCATION PLAN  
Not to Scale

NOTES

1. All levels are in metres above ordnance datum (AOD) unless noted otherwise.

LEGEND

- Order Limits
- Existing ground line
- Proposed ground line
- AOD - Above Ordnance Datum
- EGL - Existing Ground Level
- PGL - Proposed Ground Level

1 SECTION A-A - EXISTING

SCALE 1:250

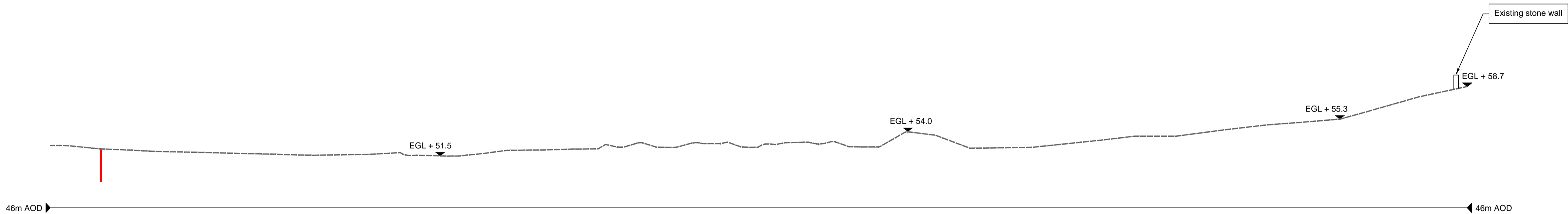

2 SECTION A-A - PROPOSED

SCALE 1:250

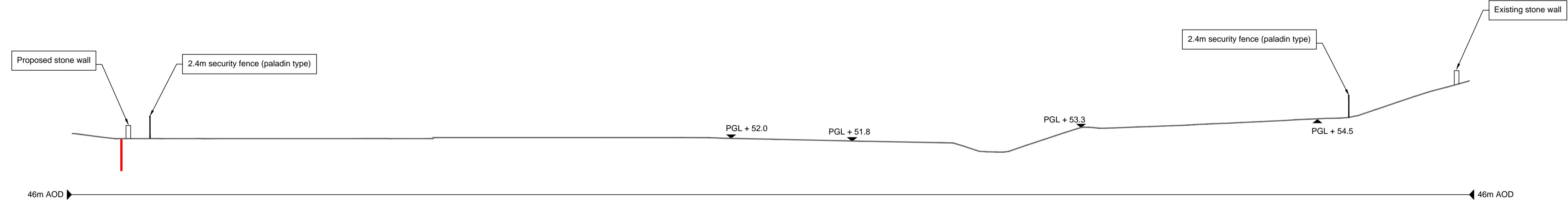

Atgynhychwyd o fapiau'r Arolwg Ordans gyda chaniatâd Rheolwr Llyfrfa Ei Mawrhydi © Hawlfraint y Goron. Mae atgynhychu heb ganiatâd yn torri hawlfraint y Goron a gallech gael eich erlyn neu gallai achos sifil gael ei ddwyn yn eich erbyn. Rhif Trwydded yr Arolwg Ordans 100051118.

Reproduced from Ordnance Survey mapping with the permission of the Controller of Her Majesty's Stationery Office © Crown copyright. Unauthorised reproduction infringes Crown copyright and may lead to prosecution or civil proceedings. Ordnance Survey Licence number 100051118.



**HORIZON**  
NUCLEAR POWER

Sunrise House, 1420 Charlton Court, Gloucester Business Park, Gloucester, GL3 4AE, UK  
Freephone: 0845 300 6816 Email: info@horizonnuclearpower.com

Project  
**WYLFA NEWYDD  
DCO PROJECT**

Drawing Title  
**OFF-SITE POWER STATION FACILITIES  
LLANFAETHLU  
EXISTING AND PROPOSED SITE  
CROSS SECTIONS**

Regulation 5 (2) (o)

Security Status					
NOT PROTECTIVELY MARKED					
Scale	1:250	Sheet Size	A1	Sheet(s)	1 of 1
Drawing Number	WN0902-HZDCO-ADV-DRG-00009				Rev 1.0

© Copyright Horizon Nuclear Power Wylfa Limited. Not to be reproduced (in full or part) without prior permission of Horizon Nuclear Power Wylfa Limited.

NOT PROTECTIVELY MARKED

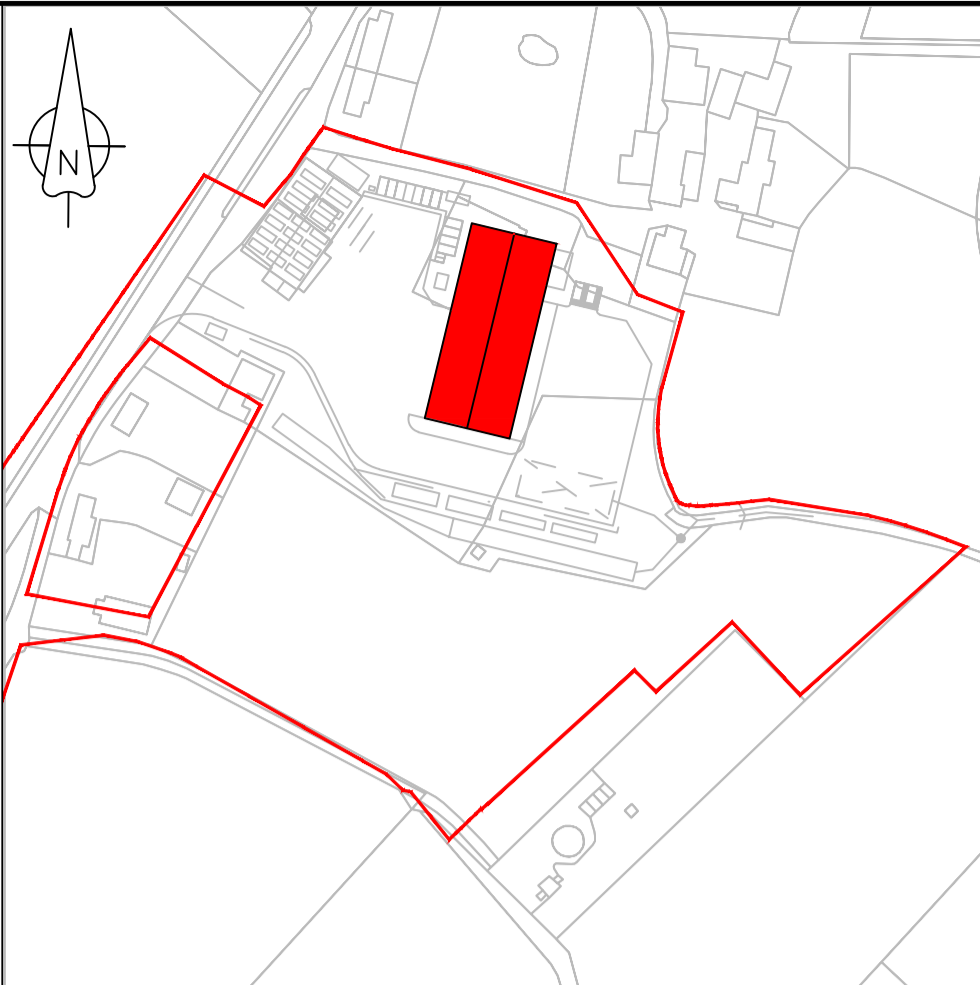

KEY PLAN

Not to Scale

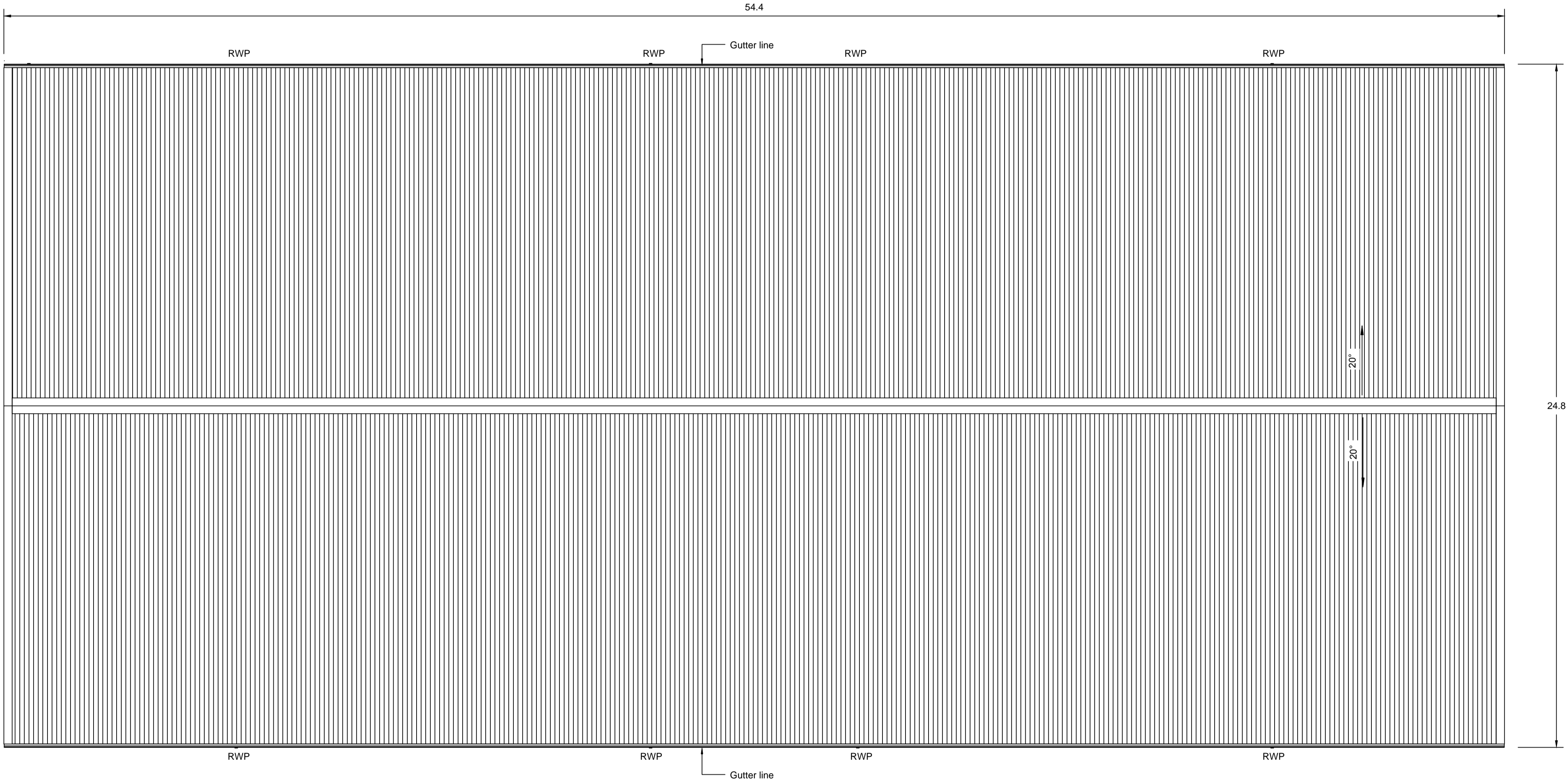

1 | ROOF PLAN

SCALE 1:100

Atgynhychwyd o fapiau'r Arolwg Ordans gyda chaniatâd Rheolwr Llyfrfa Ei Mawrhydi © Hawlfraint y Goron. Mae atgynhychu heb ganiatâd yn torri hawlfraint y Goron a gallech gael eich erlyn neu gallai achos sifil gael ei ddwyn yn eich erbyn. Rhif Trwydded yr Arolwg Ordans 100051118.

Reproduced from Ordnance Survey mapping with the permission of the Controller of Her Majesty's Stationery Office © Crown copyright. Unauthorised reproduction infringes Crown copyright and may lead to prosecution or civil proceedings. Ordnance Survey Licence number 100051118.



Notes

1. All dimensions are in metres unless noted otherwise.

LEGEND

- Order Limits
- RWP Rain Water Pipe

1.0	MARCH 2018	FOR DCO SUBMISSION	HNPWL	HNPWL	HNPWL
Rev	Rev. Date	Purpose of revision	Drawn	Checked	Approved

ILLUSTRATIVE

**HORIZON**  
NUCLEAR POWER

Sunrise House, 1420 Charlton Court, Gloucester Business Park, Gloucester, GL3 4AE, UK  
Freephone: 0845 300 6816 Email: info@horizonnuclearpower.com

Project  
**WYLFA NEWYDD  
DCO PROJECT**

Drawing Title  
**OFF-SITE POWER STATION FACILITIES  
LLANFAETHLU - MOBILE EMERGENCY  
EQUIPMENT GARAGE AND ALTERNATIVE  
EMERGENCY CONTROL CENTRE ROOF PLAN  
Regulation 5 (2) (o)**

NOT PROTECTIVELY MARKED					
Scale	1:100	Sheet Size	A1	Sheet(s)	1 of 1
Drawing Number	WN0902-HZDCO-ADV-DRG-00010				Rev 1.0

© Copyright Horizon Nuclear Power Wylfa Limited. Not to be reproduced (in full or part) without prior permission of Horizon Nuclear Power Wylfa Limited.



1 EAST ELEVATION

SCALE 1:200



2 WEST ELEVATION

SCALE 1:200

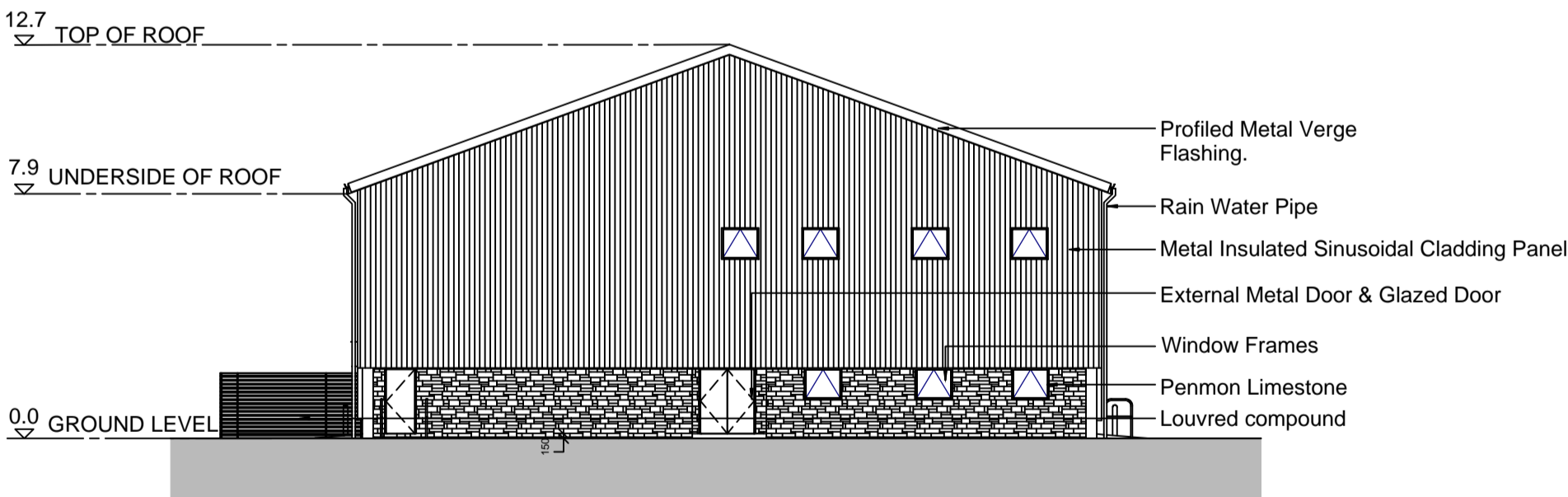

3 NORTH ELEVATION

SCALE 1:200

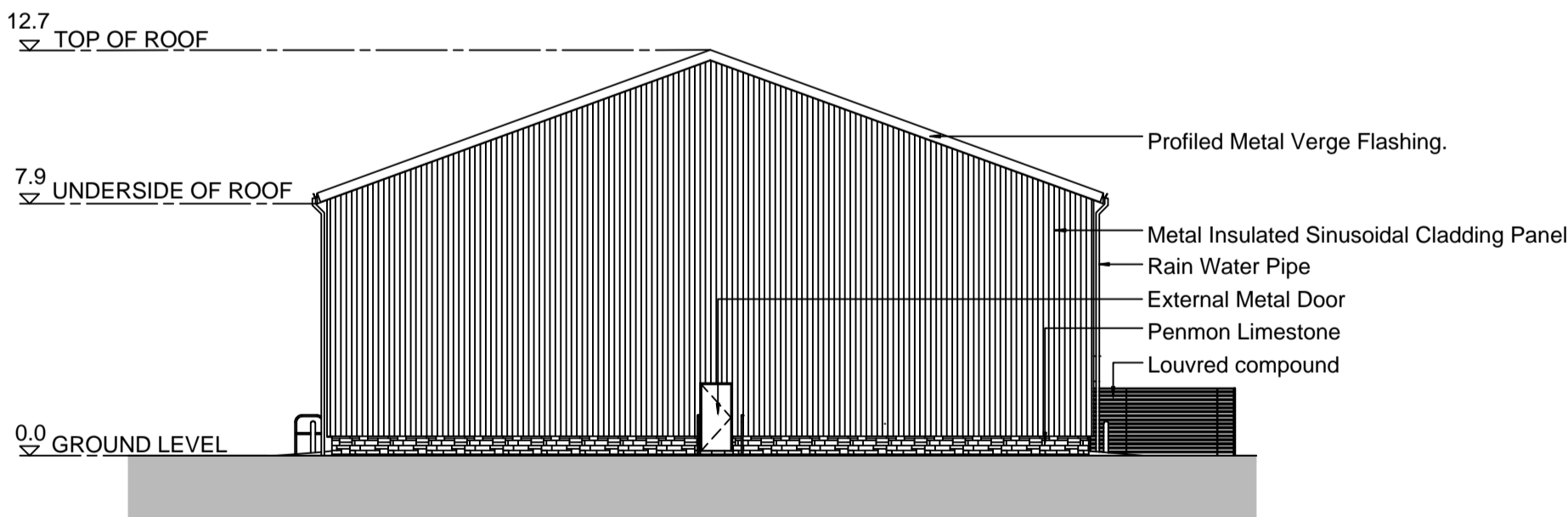

4 SOUTH ELEVATION

SCALE 1:200

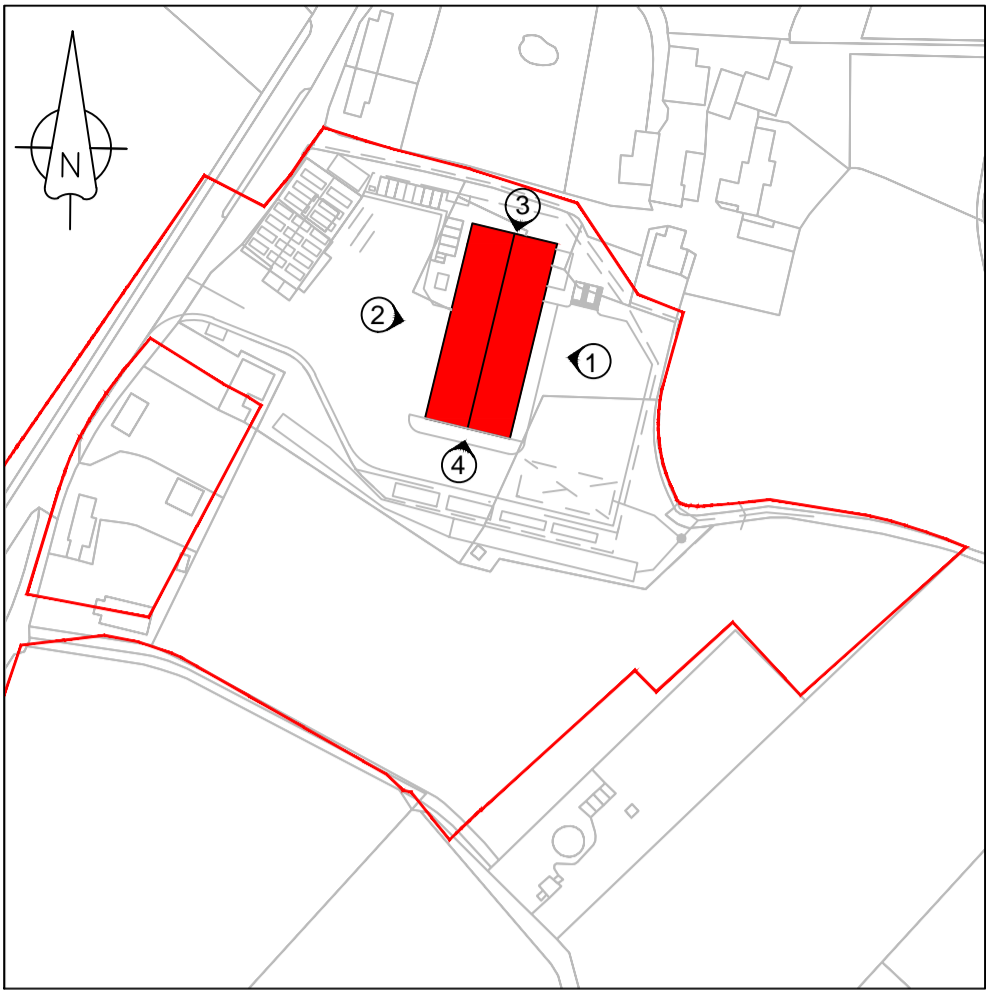

KEY PLAN

Not to Scale

NOTES

1. All levels are in metres unless noted otherwise.

LEGEND

Order Limits

Atgynhychwyd o fapiau'r Arolwg Ordans gyda chaniatâd Rheolwr Llyfrfa Ei Mawrhydi © Hawlfraint y Goron. Mae atgynhychu heb ganiatâd yn torri hawlfraint y Goron a gallech gael eich erlyn neu gallai achos sifil gael ei ddwyn yn eich erbyn. Rhif Trwydded yr Arolwg Ordans 100051118.

Reproduced from Ordnance Survey mapping with the permission of the Controller of Her Majesty's Stationery Office © Crown copyright. Unauthorised reproduction infringes Crown copyright and may lead to prosecution or civil proceedings. Ordnance Survey Licence number 100051118.



1.0	MARCH 2018	FOR DCO SUBMISSION	HNPWL	HNPWL	HNPWL
Rev	Rev. Date	Purpose of revision	Drawn	Checked	Approved

ILLUSTRATIVE

**HORIZON**  
NUCLEAR POWER

Sunrise House, 1420 Charlton Court, Gloucester Business Park, Gloucester, GL3 4AE, UK  
Freephone: 0845 300 6816 Email: info@horizonnuclearpower.com

Project  
**WYLFA NEWYDD  
DCO PROJECT**

Drawing Title  
**OFF-SITE POWER STATION FACILITIES  
LLANFAETHLU - MOBILE EMERGENCY  
EQUIPMENT GARAGE AND ALTERNATIVE  
EMERGENCY CONTROL CENTRE ELEVATIONS  
Regulation 5 (2) (o)**

Security Status						
NOT PROTECTIVELY MARKED						
Scale	1:200	Sheet Size	A1	Sheet(s)	1 of 1	
Drawing Number					Rev	
WN0902-HZDCO-ADV-DRG-00011					1.0	

© Copyright Horizon Nuclear Power Wylfa Limited. Not to be reproduced (in full or part) without prior permission of Horizon Nuclear Power Wylfa Limited.

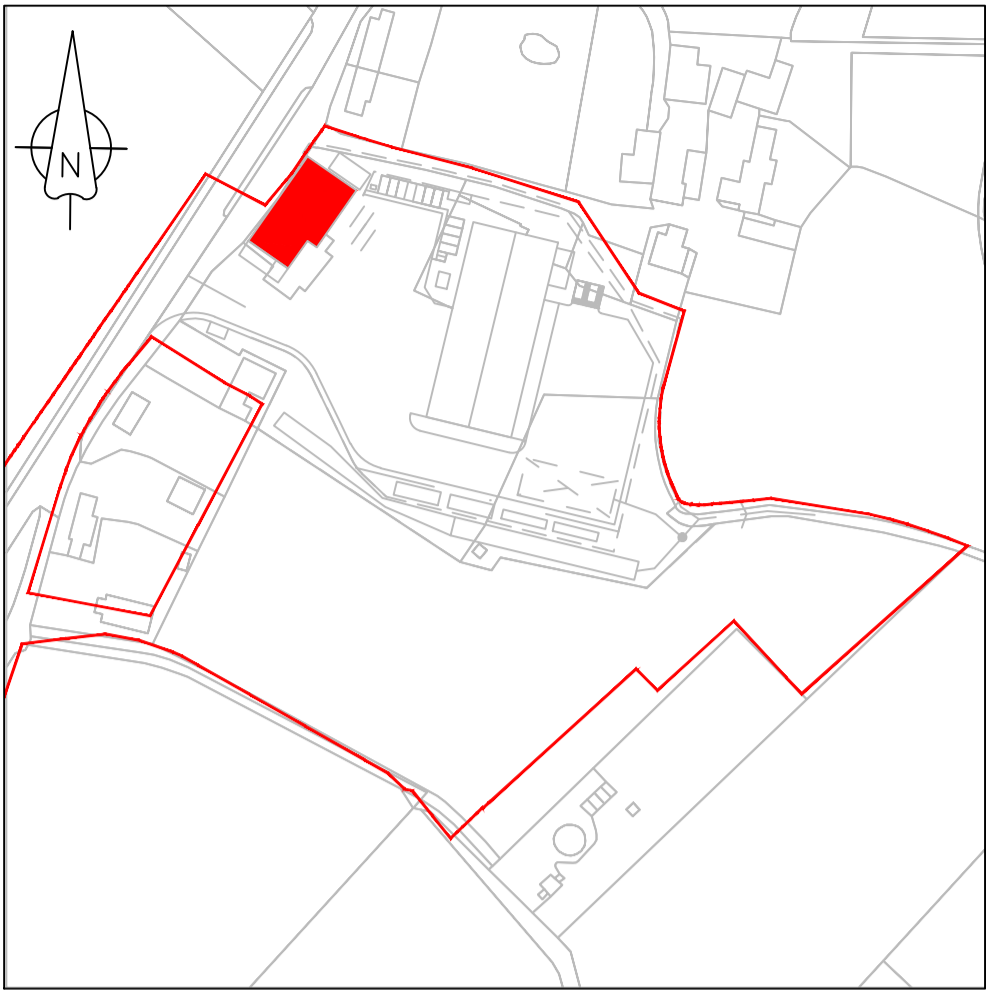

KEY PLAN

Not to Scale

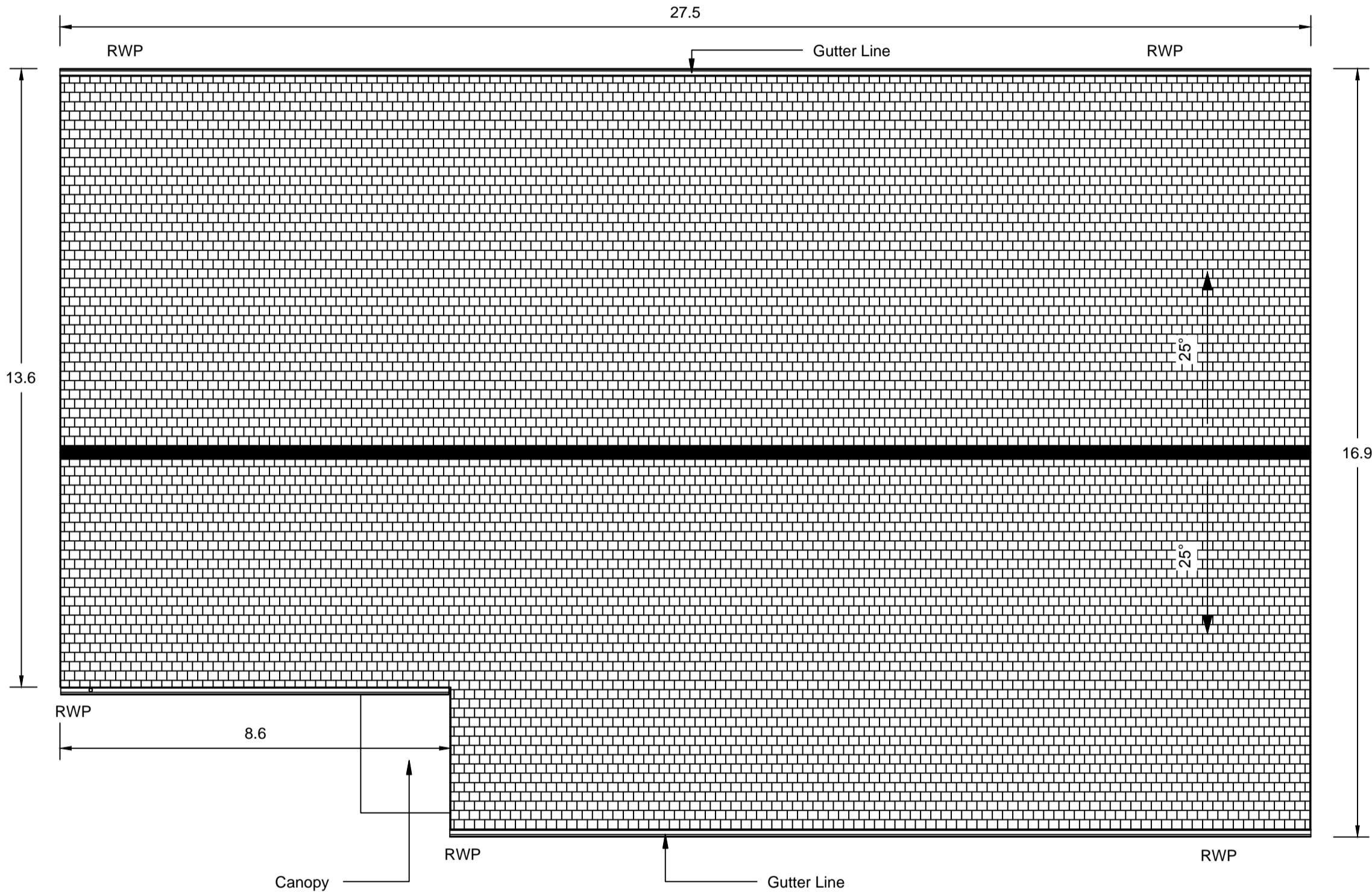

1 | ROOF PLAN

SCALE 1:100

Atgynhychwyd o fapiau'r Arolwg Ordans gyda chaniatâd Rheolwr Llyfrfa Ei Mawrhydi © Hawlfraint y Goron. Mae atgynhyrchu heb ganiatâd yn torri hawlfraint y Goron a gallech gael eich erlyn neu gallai achos sifil gael ei ddwyn yn eich erbyn. Rhif Trwydded yr Arolwg Ordans 100051118.

Reproduced from Ordnance Survey mapping with the permission of the Controller of Her Majesty's Stationery Office © Crown copyright. Unauthorised reproduction infringes Crown copyright and may lead to prosecution or civil proceedings. Ordnance Survey Licence number 100051118.



Notes					
1. All dimensions are in metres unless noted otherwise.					
LEGEND					
<div><div></div>Order Limits</div> <div><div>RWP</div><div>Rain Water Pipe</div></div>					
1.0	MARCH 2018	FOR DCO SUBMISSION		HNPWL	HNPWL
Rev	Rev. Date	Purpose of revision	Drawn	Checked	Approved
ILLUSTRATIVE					
<div><div><div>HORIZON</div><div>NUCLEAR POWER</div></div><div>Sunrise House, 1420 Charlton Court, Gloucester Business Park, Gloucester, GL3 4AE, UK Freephone: 0845 300 6616 Email: info@horizonnuclearpower.com</div></div>					
Project <div>WYLFA NEWYDD DCO PROJECT</div>					
Drawing Title <div>OFF-SITE POWER STATION FACILITIES LLANFAETHLU ENVIRONMENTAL SURVEY LABORATORY ROOF PLAN</div>					
Regulation 5 (2) (o)					
Security Status <div>NOT PROTECTIVELY MARKED</div>					
Scale	1:100	Sheet Size	A1	Sheet(s)	1 of 1
Drawing Number				Rev	
WN0902-HZDCO-ADV-DRG-00012				1.0	
© Copyright Horizon Nuclear Power Wylfa Limited. Not to be reproduced (in full or part) without prior permission of Horizon Nuclear Power Wylfa Limited.					

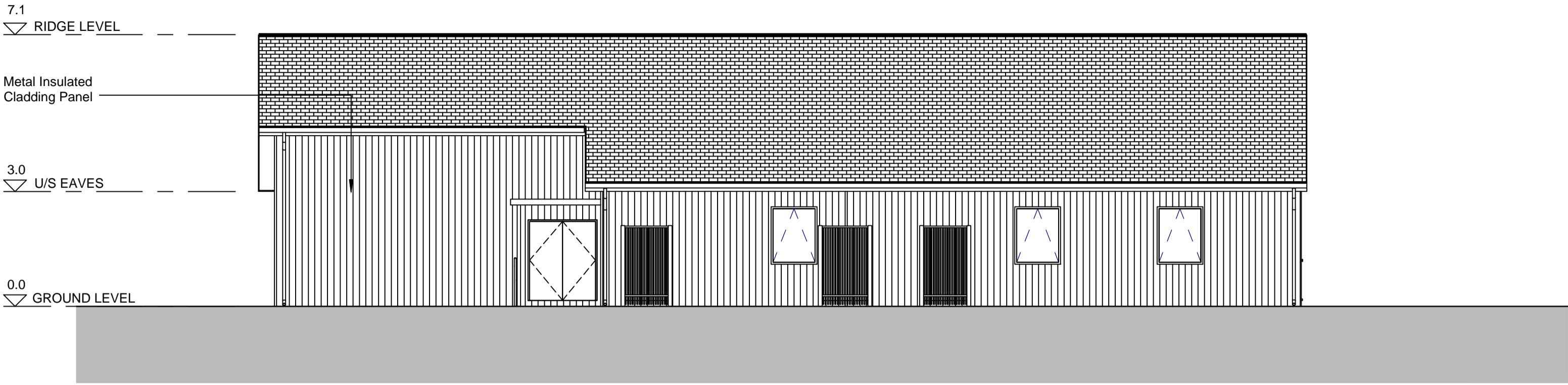

1 EAST ELEVATION  
SCALE 1:100

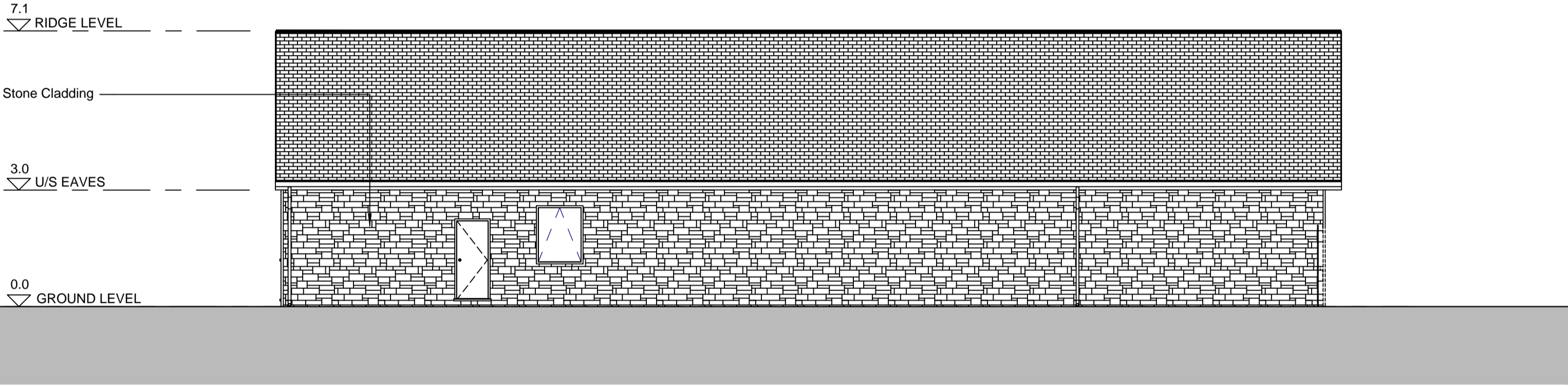

2 WEST ELEVATION  
SCALE 1:100

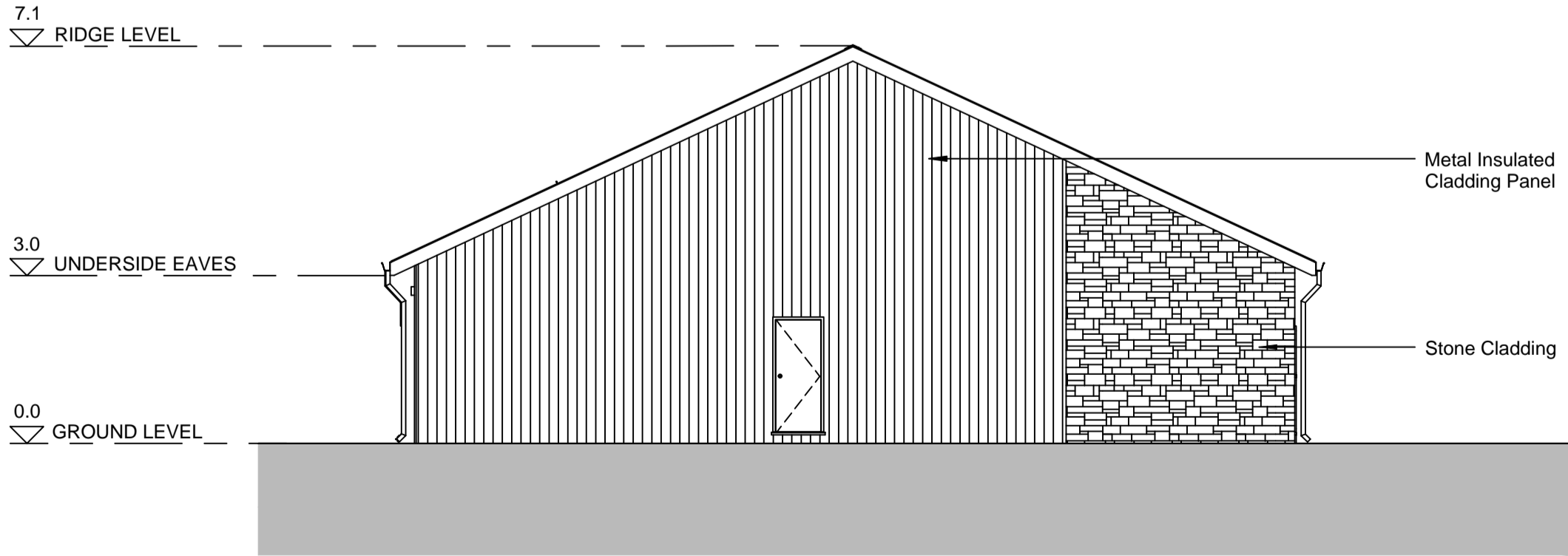

3 NORTH ELEVATION  
SCALE 1:100

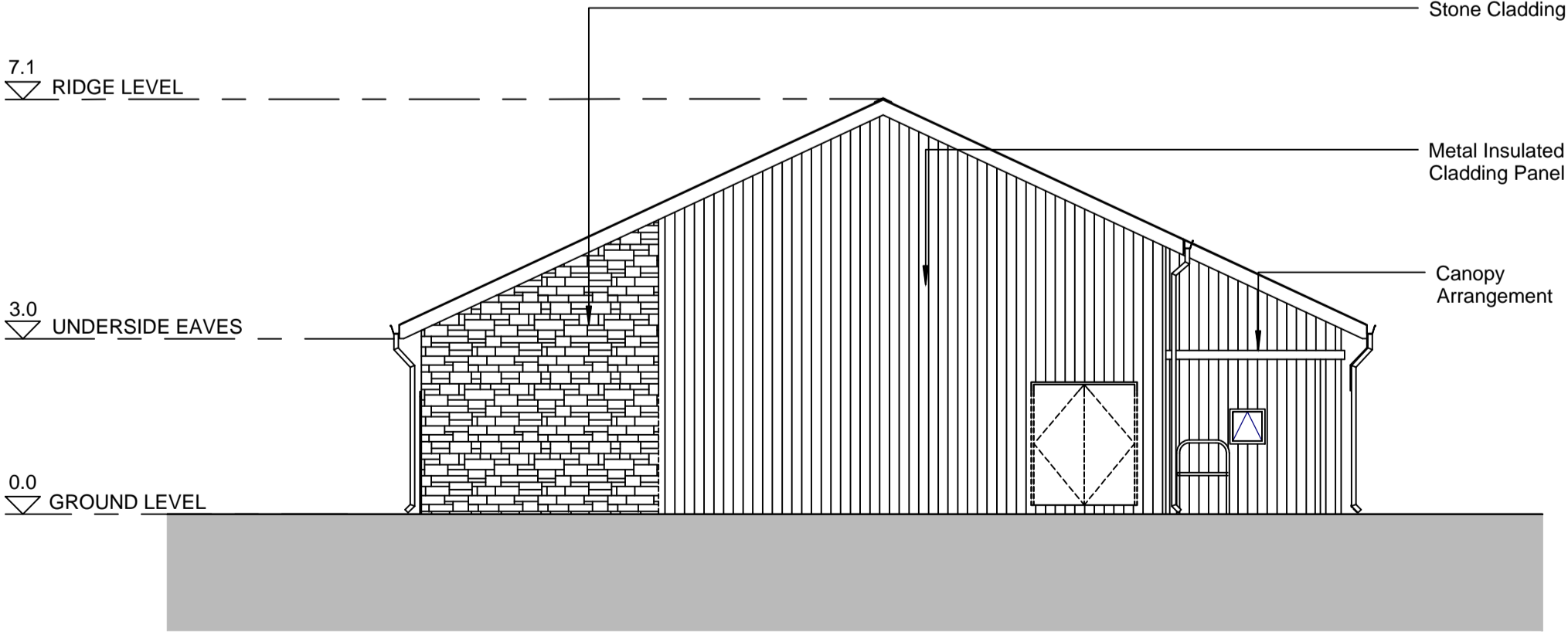

4 SOUTH ELEVATION  
SCALE 1:100

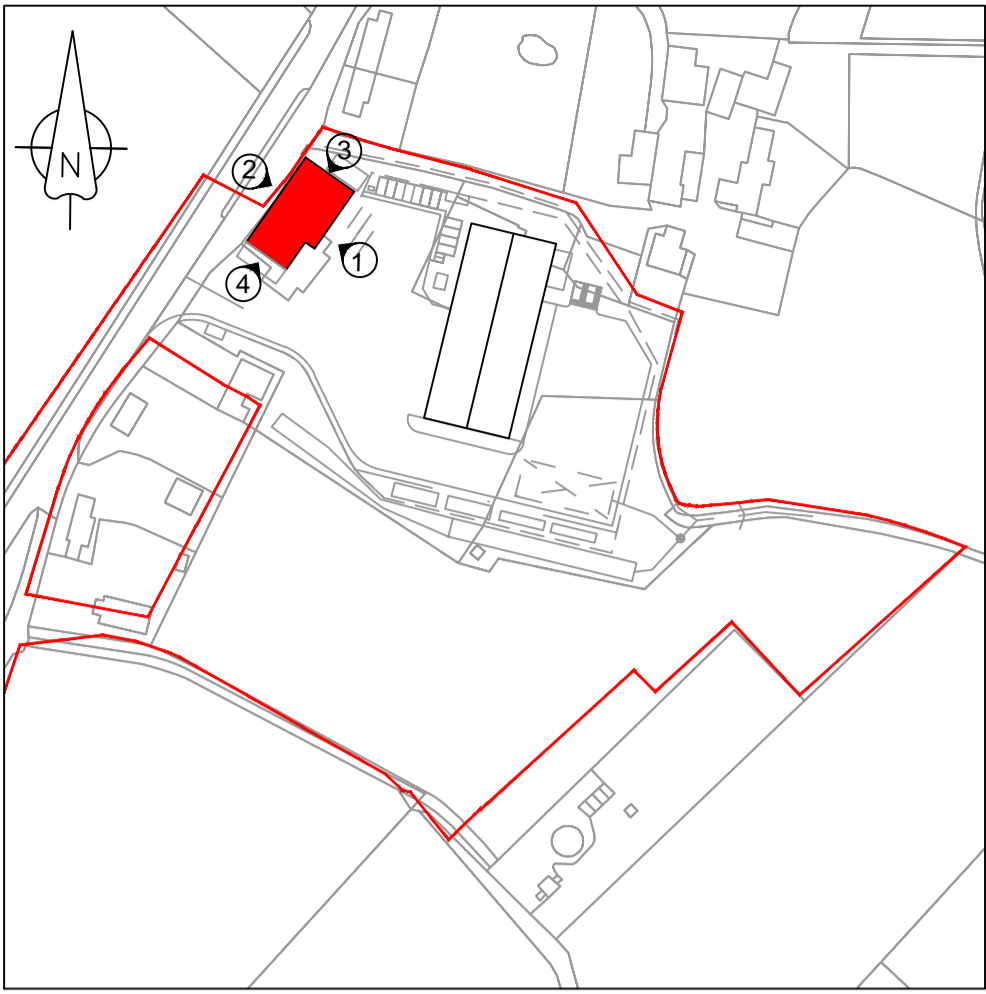

KEY PLAN  
Not to Scale

NOTES

1. All levels are in metres unless noted otherwise.

LEGEND

Order Limits

1.0	MARCH 2018	FOR DCO SUBMISSION	HNPWL	HNPWL	HNPWL
Rev	Rev. Date	Purpose of revision	Drawn	Checked	Approved

ILLUSTRATIVE

**HORIZON**  
NUCLEAR POWER

Sunrise House, 1420 Charlton Court, Gloucester Business Park, Gloucester, GL3 4AE, UK  
Freephone: 0845 300 6816 Email: info@horizonnuclearpower.com

Project  
**WYLFA NEWYDD  
DCO PROJECT**

Drawing Title  
**OFF-SITE POWER STATION FACILITIES  
LLANFAETHLU  
ENVIRONMENTAL SURVEY LABORATORY  
ELEVATIONS**

Regulation 5 (2) (o)

Security Status

NOT PROTECTIVELY MARKED					
Scale	1:100	Sheet Size	A1	Sheet(s)	1 of 1
Drawing Number	WN0902-HZDCO-ADV-DRG-00013				Rev 1.0

© Copyright Horizon Nuclear Power Wylfa Limited. Not to be reproduced (in full or part) without prior permission of Horizon Nuclear Power Wylfa Limited.

Atgynhychwyd o fapiau'r Arolwg Ordnans gyda chaniatâd Rheolwr Llyfrfa Ei Mawrhydi © Hawlfraint y Goron. Mae atgynhychu heb ganiatâd yn torri hawlfraint y Goron a gallech gael eich erlyn neu gallai achos sifil gael ei ddwyn yn eich erbyn. Rhif Trwydded yr Arolwg Ordnans 100051118.

Reproduced from Ordnance Survey mapping with the permission of the Controller of Her Majesty's Stationery Office © Crown copyright. Unauthorised reproduction infringes Crown copyright and may lead to prosecution or civil proceedings. Ordnance Survey Licence number 100051118.



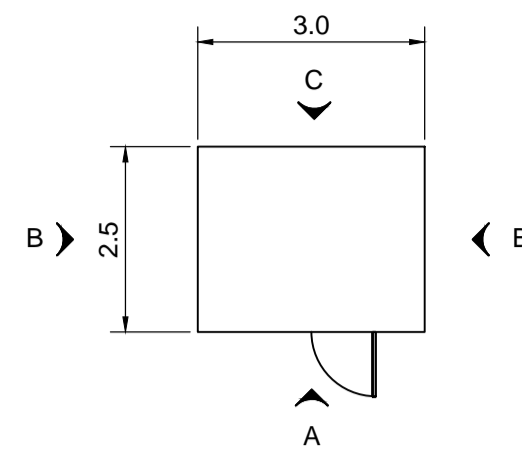

SUBSTATION PLAN  
(BUILDING C)

1:100

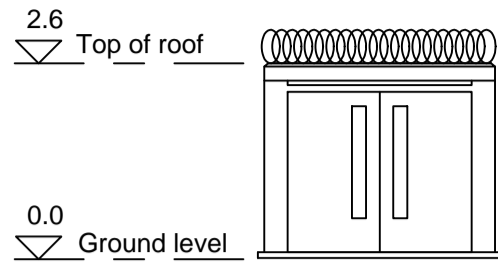

ELEVATION A  
(SUBSTATION)

1:100

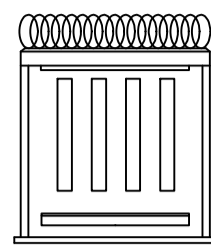

ELEVATION B  
(SUBSTATION)

1:100

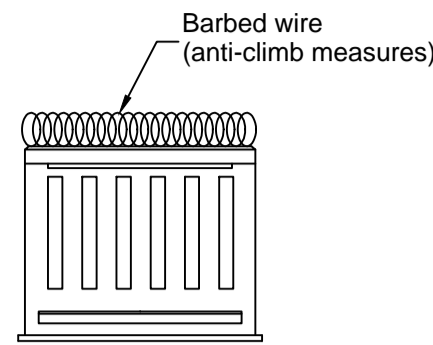

ELEVATION C  
(SUBSTATION)

1:100

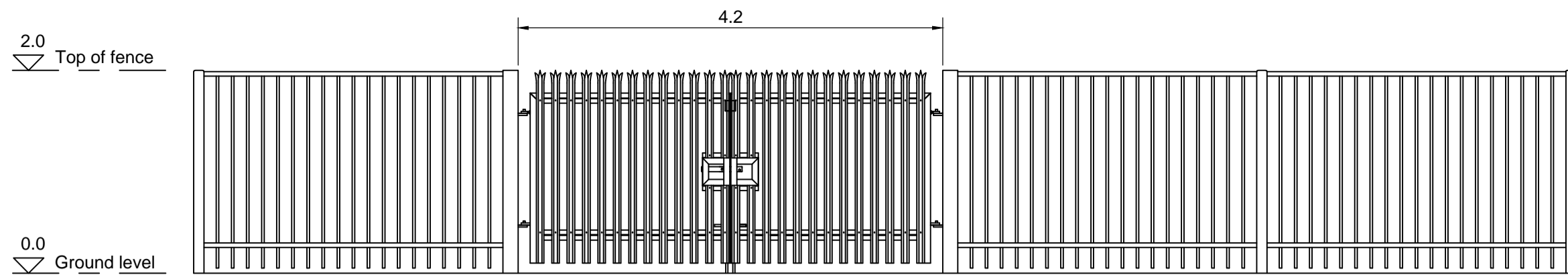

TYPICAL ELEVATION ON EXTERNAL PLANT AREA  
COMPOUND PALISADE TYPE FENCING AND GATE

1:50

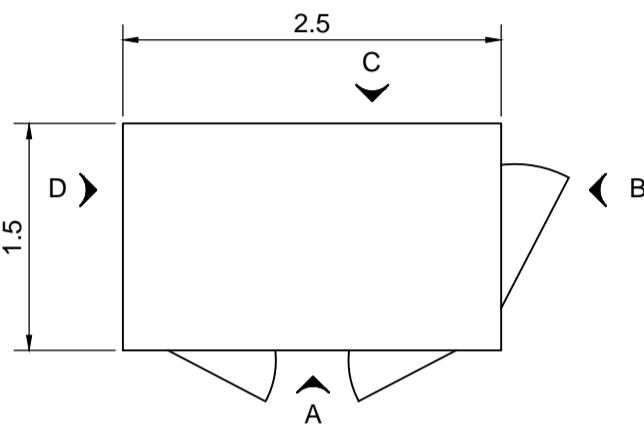

GENERATOR PLAN  
(ELEMENT E)

1:50

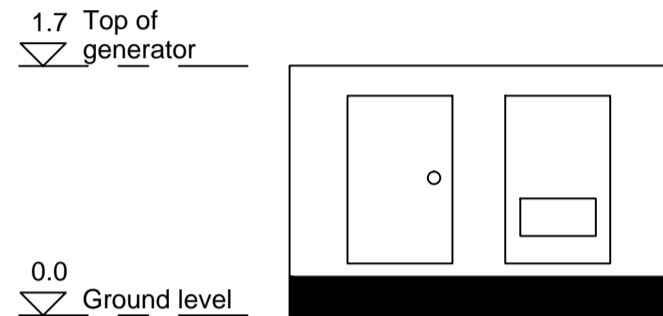

ELEVATION A  
(GENERATOR)

1:50

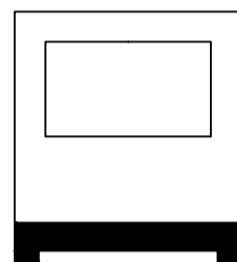

ELEVATION B  
(GENERATOR)

1:50



ELEVATION C  
(GENERATOR)

1:50

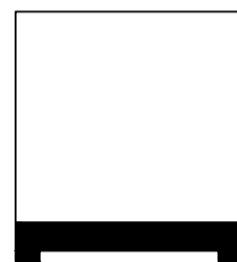

ELEVATION D  
(GENERATOR)

1:50

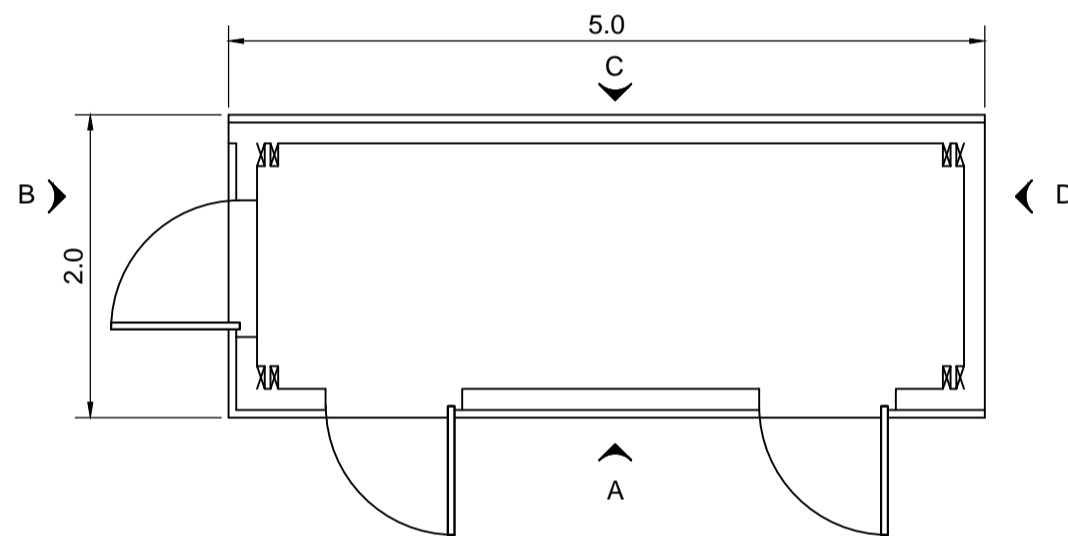

SPRINKLER PUMPHOUSE PLAN  
(BUILDING D)

1:50

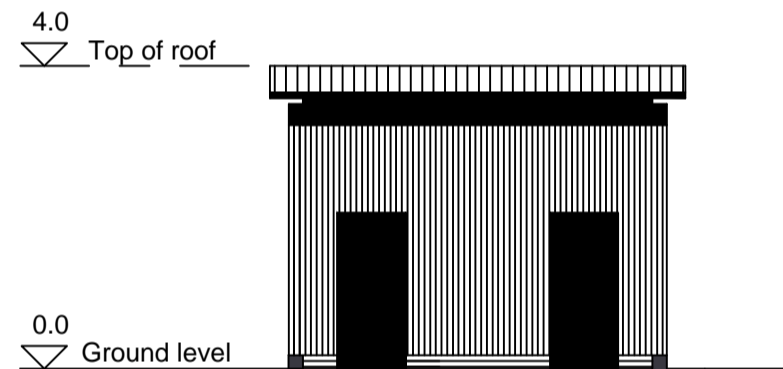

ELEVATION A  
(SPRINKLER PUMPHOUSE)

1:100

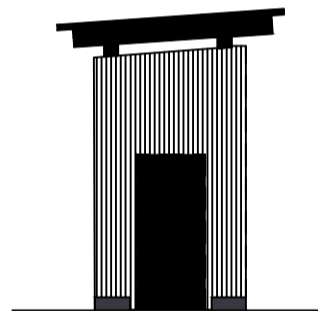

ELEVATION B  
(SPRINKLER PUMPHOUSE)

1:100

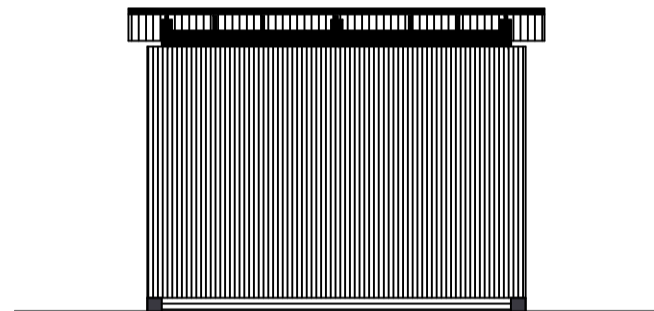

ELEVATION C  
(SPRINKLER PUMPHOUSE)

1:100

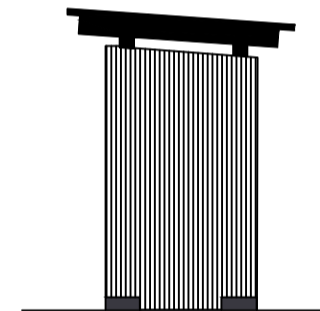

ELEVATION D  
(SPRINKLER PUMPHOUSE)

1:100

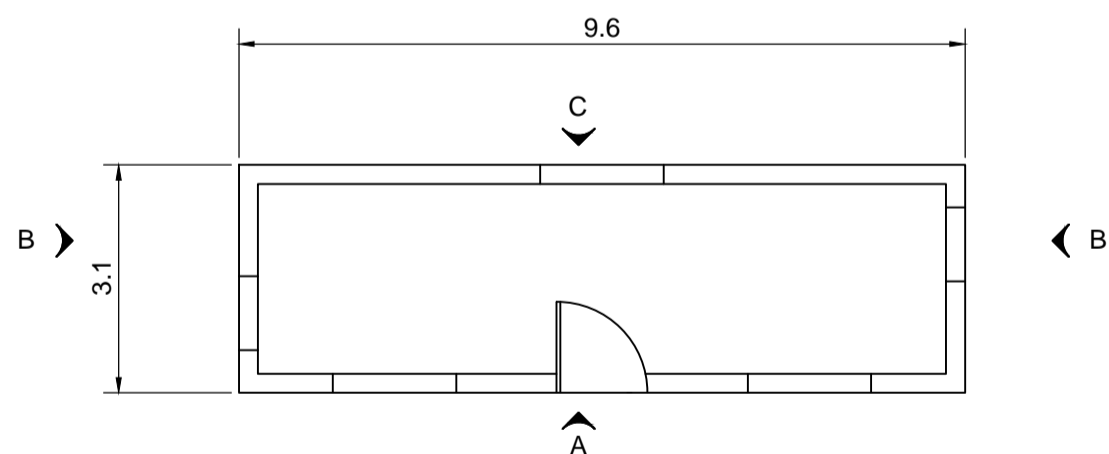

PORTACABIN PLAN

1:100

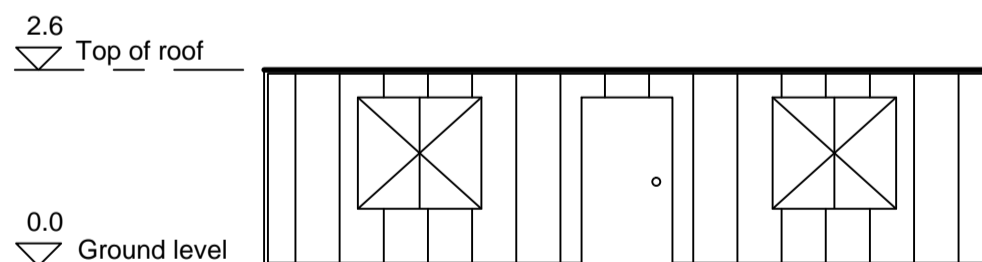

ELEVATION A  
(PORTACABIN)

1:100

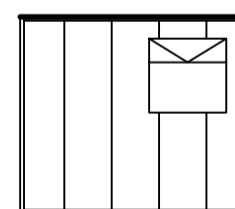

ELEVATION B  
(PORTACABIN)

1:100

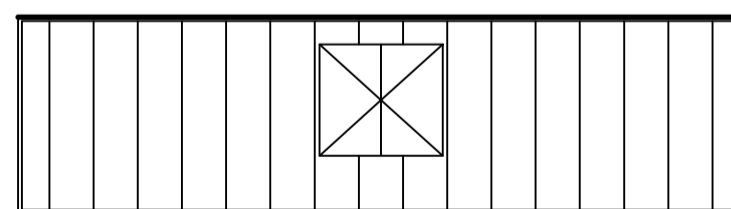

ELEVATION C  
(PORTACABIN)

1:100

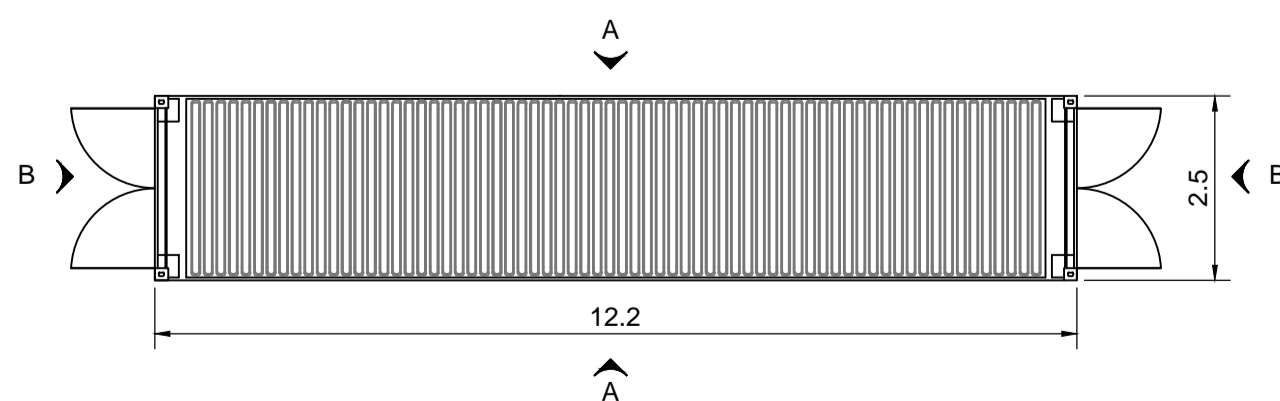

SHIPPING CONTAINER PLAN

1:100

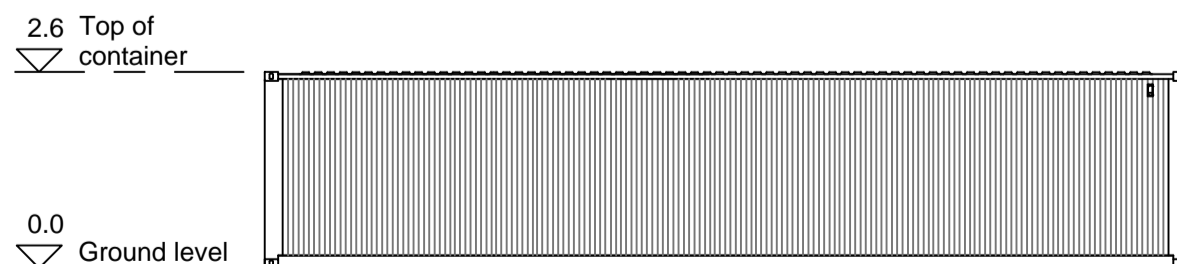

ELEVATION A  
(SHIPPING CONTAINER)

1:100

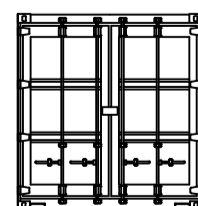

ELEVATION B  
(SHIPPING CONTAINER)

1:100

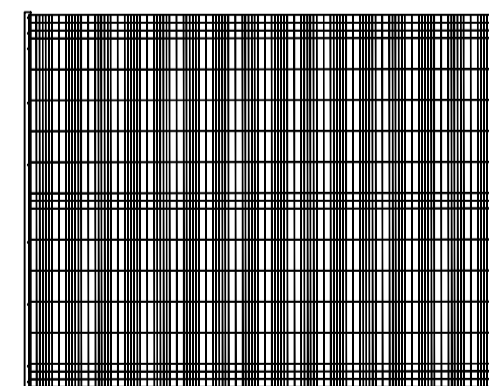

FENCE DETAIL  
(2.4 HIGH PALADIN TYPE FENCE)

1:50

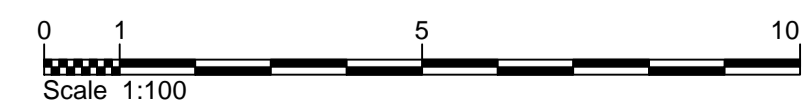
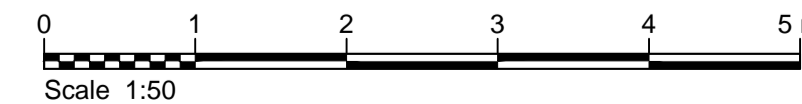

NOTES					
1. All Dimensions are in metres unless noted otherwise.					
2. All levels are in metres unless noted otherwise.					
1.0	MARCH 2018	FOR DCO SUBMISSION		HNPWL	HNPWL
Rev	Rev. Date	Purpose of revision		Drawn	Checked
ILLUSTRATIVE					
<div><div>HORIZON</div><div>NUCLEAR POWER</div><div>Sunrise House, 1420 Charlton Court, Gloucester Business Park, Gloucester, GL3 4AE, UK Freephone: 0845 300 6816 Email: info@horizonnuclearpower.com</div></div>					
Project					
WYLFA NEWYDD DCO PROJECT					
Drawing Title					
OFF-SITE POWER STATION FACILITIES LLANFAETHLU MISCELLANEOUS BUILDINGS AND STRUCTURES - PLANS AND ELEVATIONS Regulation 5 (2) (o)					
Security Status					
NOT PROTECTIVELY MARKED					
Scale	As Shown	Sheet Size	A1	Sheet(s)	1 of 1
Drawing Number		WN0902-HZDCO-ADV-DRG-00015			Rev
					1.0